

REQUIRED TOOLS AND MATERIALS:



- Two (2) Capable Adults



- Tape Measure



- Wood Board 6" x 6" (scrap)



- Sawhorse or Support Table

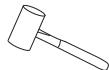

- Hammer

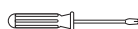

- #2 or #3 Phillips Screwdriver



- Safety Glasses



- Step Ladder 8ft. (2.4 m)

- (2 each) Wrenches and/or Socket Wrenches and Sockets (Deep-Well Sockets are Recommended).

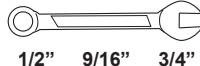

AND/OR



- Extension is Recommended.

- Garden Hose or Sand

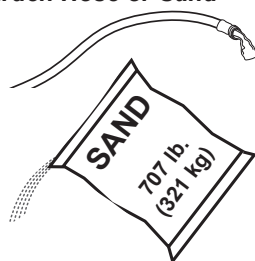

OPTIONAL TOOLS AND MATERIALS:

- Large and Small Adjustable Wrenches

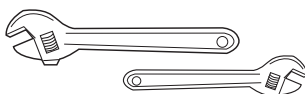

Art.Nr. 2378709

SPALDING

TRUE TO THE GAME™

NBA Arena Portable System

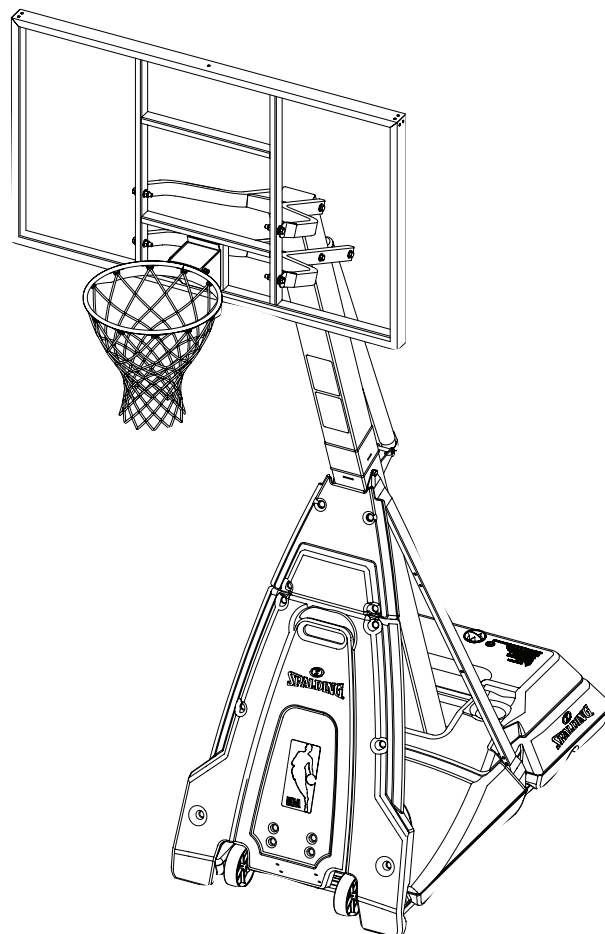

WARNING!



PLEASE ENSURE

that (4) steel spacers are in place between Board Frame and Rim Prior to tightening bolts. (SEE PAGE 21)

FAILURE TO FOLLOW OPERATING INSTRUCTIONS COULD RESULT IN INJURY OR DAMAGE TO PROPERTY.

Adult Assembly Required.

This manual, accompanied by sales receipt, should be saved and kept on hand as a convenient reference, as it contains important information about your model.



WARNING!

READ AND UNDERSTAND OPERATOR'S MANUAL BEFORE USING THIS UNIT.

FAILURE TO FOLLOW OPERATING INSTRUCTIONS COULD RESULT IN INJURY OR DAMAGE TO PROPERTY.

Write Model Number From Box Here:

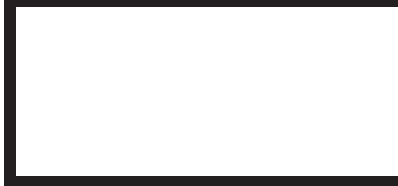

Toll-Free Customer Service Number for U.S: 1-800-772-5346, For Canada: 1-800-284-8339,

For Europe: 00 800 555 85234 (Sweden: 009 555 85234), For Australia: 1300 367 582

Internet Address: www.spalding.com www.spalding.com.au



! WARNING

Read and understand warnings listed below before using this product.

Failure to follow these warnings may result in serious injury and/or property damage.

Owner must ensure that all players know and follow these rules for safe operation of the system.

- **DO NOT HANG** on the rim or any part of the system including backboard, support braces or net.
- During play, especially when performing dunk type activities, keep player's face away from the backboard, rim and net. Serious injury could occur if teeth/face come in contact with backboard, rim or net.
- Do not slide, climb, shake or play on base and/or pole.
- After assembly is complete, fill system completely with water or sand and stake to the ground. Never leave system in an upright position without filling base with weight, as system may tip over causing injuries.
- When adjusting height or moving system, keep hands and fingers away from moving parts.
- Do not allow children to move or adjust system.
- During play, do not wear jewelry (rings, watches, necklaces, etc.). Objects may entangle in net.
- Surface beneath the base must be smooth and free of gravel or other sharp objects. Punctures cause leakage and could cause system to tip over.
- Keep organic material away from pole base. Grass, litter, etc. could cause corrosion and/or deterioration.
- Check pole system for signs of corrosion (rust, pitting, chipping) and repaint with exterior enamel paint. If rust has penetrated through the steel anywhere, replace pole immediately.
- Check system before each use for proper ballast, loose hardware, excessive wear and signs corrosion and repair before use.
- Check system before each use for instability.
- Do not use system during windy and/or severe weather conditions; system may tip over. Place system in the storage position and/or in an area protected from the wind and free from personal property and/or overhead wires.
- Never play on damaged equipment.
- See instruction manual for proper installation and maintenance.
- When moving system, use caution to keep mechanism from shifting.
- Keep pole top covered with cap at all times.
- Do not allow water in tank to freeze. During sub-freezing weather add 2 gallons of non-toxic antifreeze, sand or empty tank completely and store. (Do not use salt.)
- While moving system, do not allow anyone to stand or sit on base or have added ballasting on base.
- Do not leave system unsupervised or play on system when wheels are engaged for moving.
- Use Caution when moving system across uneven surfaces. System may tip over.
- Use extreme caution if placing system on sloped surface. System may tip over more easily.

SPALDING

In the U.S.: 1-800-558-5234
In Canada: 1-800-284-8339
In Australia: 1-300-367-582

SURE SHOT

In the U.S.: 1-800-558-5234

RUSSELL

Trademarks registered
in the USA and other countries.

ID#: 55679001 02/12

HYDRA-RIB

In the U.S.: 1-800-334-9111

HUFFY SPORTS

In the U.S.: 1-800-558-5234
In Canada: 1-800-284-8339

53

HEIGHT ADJUSTMENT

Rotate crank handle to raise and lower backboard.

Do not over crank handle beyond the manufactured height indicator range of 7-1/2 - 10 feet. Damage may be caused to the screw jack's internal adjustment mechanism if adjusted over 10 or under 7-1/2 feet.

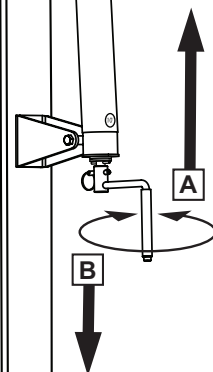

MOVING SYSTEM

1. Adjust basketball backboard height to lowest position.
2. Rotate handle forward until wheels engage ground.
3. Move basketball system to desired location.
4. Rotate handle back to original position.
5. Check system for stability.

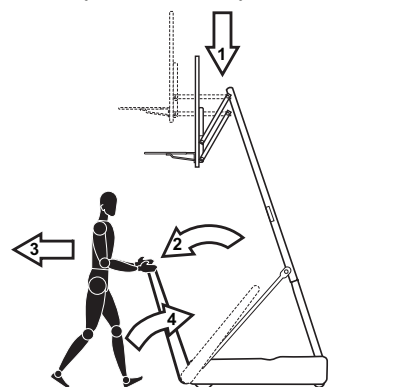

574090 12/06



SAFETY INSTRUCTIONS



FAILURE TO FOLLOW THESE SAFETY INSTRUCTIONS MAY RESULT IN SERIOUS INJURY OR PROPERTY DAMAGE AND WILL VOID WARRANTY.

Owner must ensure that all players know and follow these rules for safe operation of the system.

To ensure safety, do not attempt to assemble this system without following the instructions carefully. Check entire box and inside all packing material for parts and/or additional instruction material. Before beginning assembly, read the instructions and identify parts using the hardware identifier and parts list in this document. Proper and complete assembly, use, and supervision are essential for proper operation and to reduce the risk of accident or injury. A high probability of serious injury exists if this system is not installed, maintained, and operated properly.

- If using a ladder during assembly, use extreme caution.
- Two (2) capable adults are recommended for this operation.
- Check base regularly for leakage. Slow leaks could cause system to tip over unexpectedly.
- Seat the pole sections properly (if applicable). Failure to do so could allow the pole sections to separate during play and/or transport of the system.
- Climate, corrosion, or misuse could result in system failure.
- Minimum operational height is 6' 6" (1.98 m) to the bottom of backboard.
- This equipment is intended for home recreational use only and NOT excessive competitive play.
- Read and understand the warning label affixed to pole.
- The life of your basketball pole depends on many conditions. The climate, placement of the pole, location of the pole, exposure to corrosives such as pesticides, herbicides, or salts are all important.
- If technical assistance is required, contact Customer Service.
- Adult supervision is recommended when adjusting height.

Most injuries are caused by misuse and/or not following instructions. Use caution when using this system.



BEFORE YOU START!

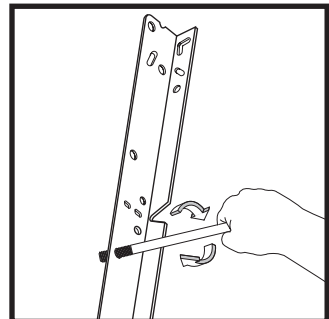
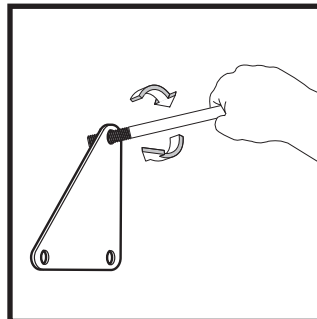
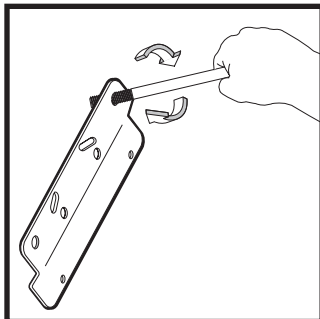
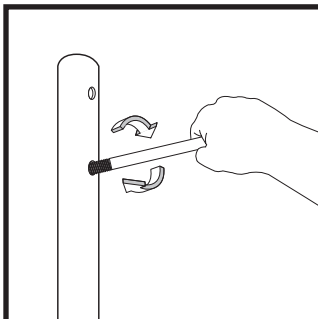

To ensure optimal playability of backboard system, a close tolerance fit between the elevator components and hardware is required. Test-fit large bolts into large holes of elevator tubes, backboard brackets, and triangle plates. Carefully rock them in a circular motion to ream out any excess paint from holes if necessary.

Not all items pictured are included with every model.

IDENTIFY HARDWARE CARDS

To make the assembly easier we have separated the hardware per section.
Each hardware card is dedicated to a specific assembly area.
Open each individually as you progress through the steps. Do not open them all at once.

BASE TO POLE HARDWARE CARD

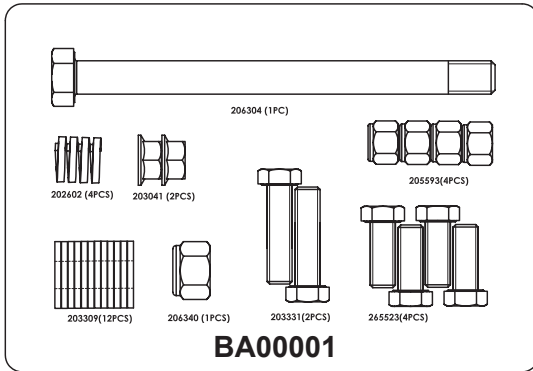

FRONT WHEEL ASSEMBLY HARDWARE CARD

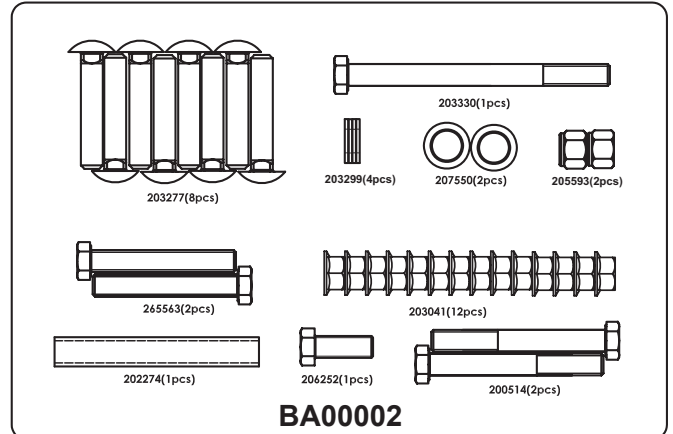

ELEVATOR TO POLE CONNECTION HARDWARE CARD

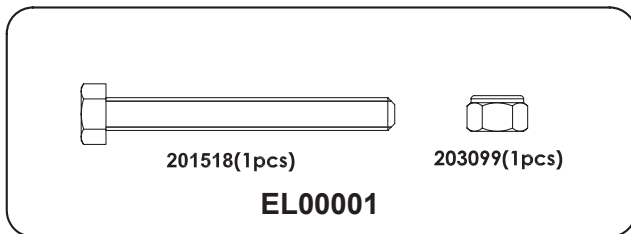

ELEVATOR ARMS HARDWARE CARD

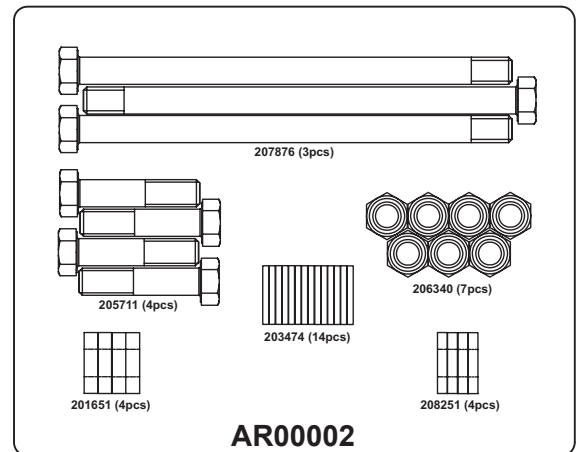

RIM ATTACHMENT HARDWARE CARD AND BAG

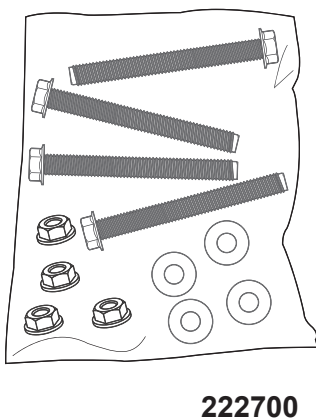

POLE TO POLE HARDWARE BAG

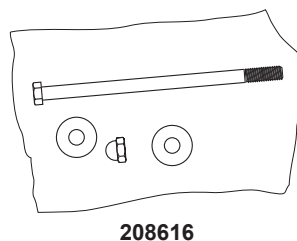

STADIUM AND BOARD PAD HARDWARE CARD

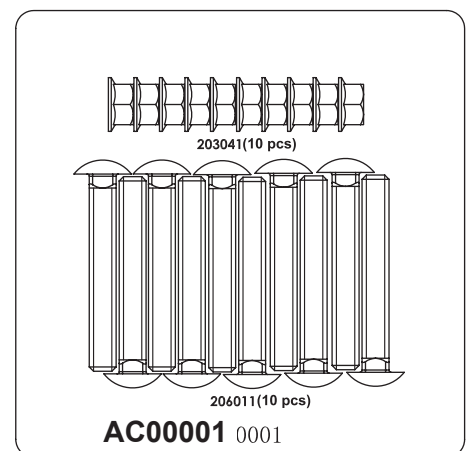



Questions or Missing Parts?

DON'T go back to store!

Call TOLL-FREE Customer Service
Number listed on the front page!

IMPORTANT!

**Remove all contents from boxes.
Be sure to check inside pole sections,
hardware and additional parts are packed inside.**

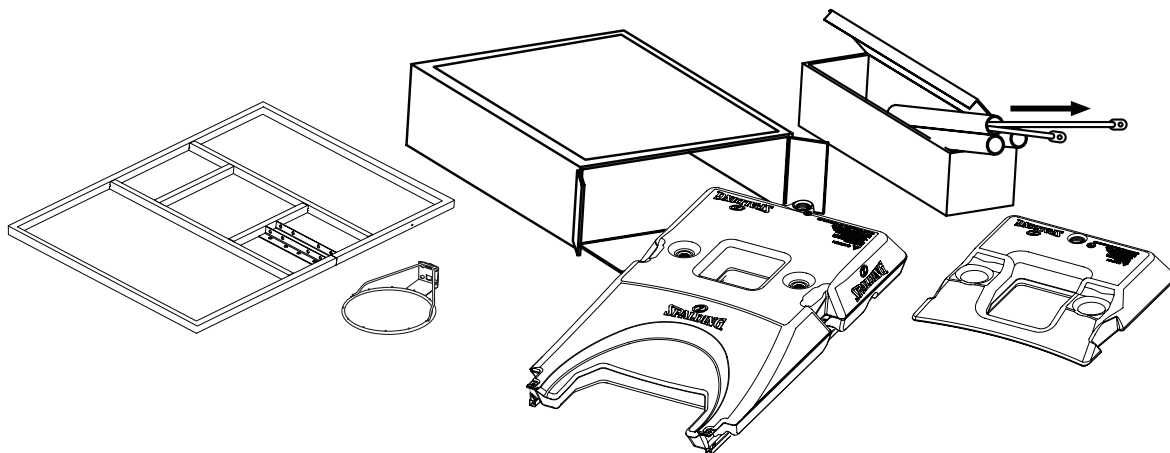

NOTICE TO ASSEMBLERS

Adult Assembly Required. Dispose of ALL packaging materials promptly. As with all products, periodically inspect for loose small parts.

Assembled unit MUST be filled with sand or water at ALL times.

ALL basketball systems, including those used for DISPLAYS, MUST be assembled and installed according to instructions. Failure to follow instructions could result in SERIOUS INJURY. It is NOT acceptable to devise a makeshift support system.



WARNING!



IF YOUR SYSTEM IS EQUIPPED WITH AN ACRYLIC BACKBOARD, EXAMINE BACKBOARD FOR ANY DAMAGE THAT MAY HAVE OCCURRED DURING SHIPMENT. CRACKS IN THE BACKBOARD COULD RESULT IN SUDDEN BREAKAGE. IF BACKBOARD IS DAMAGED IN ANY WAY PRIOR TO OR AFTER ASSEMBLY, CALL TOLL-FREE NUMBER: U.S. 1-800-558-5234; CANADA: 1-800-284-8339; <http://www.spalding.com>

FRONT VIEW

BACK VIEW

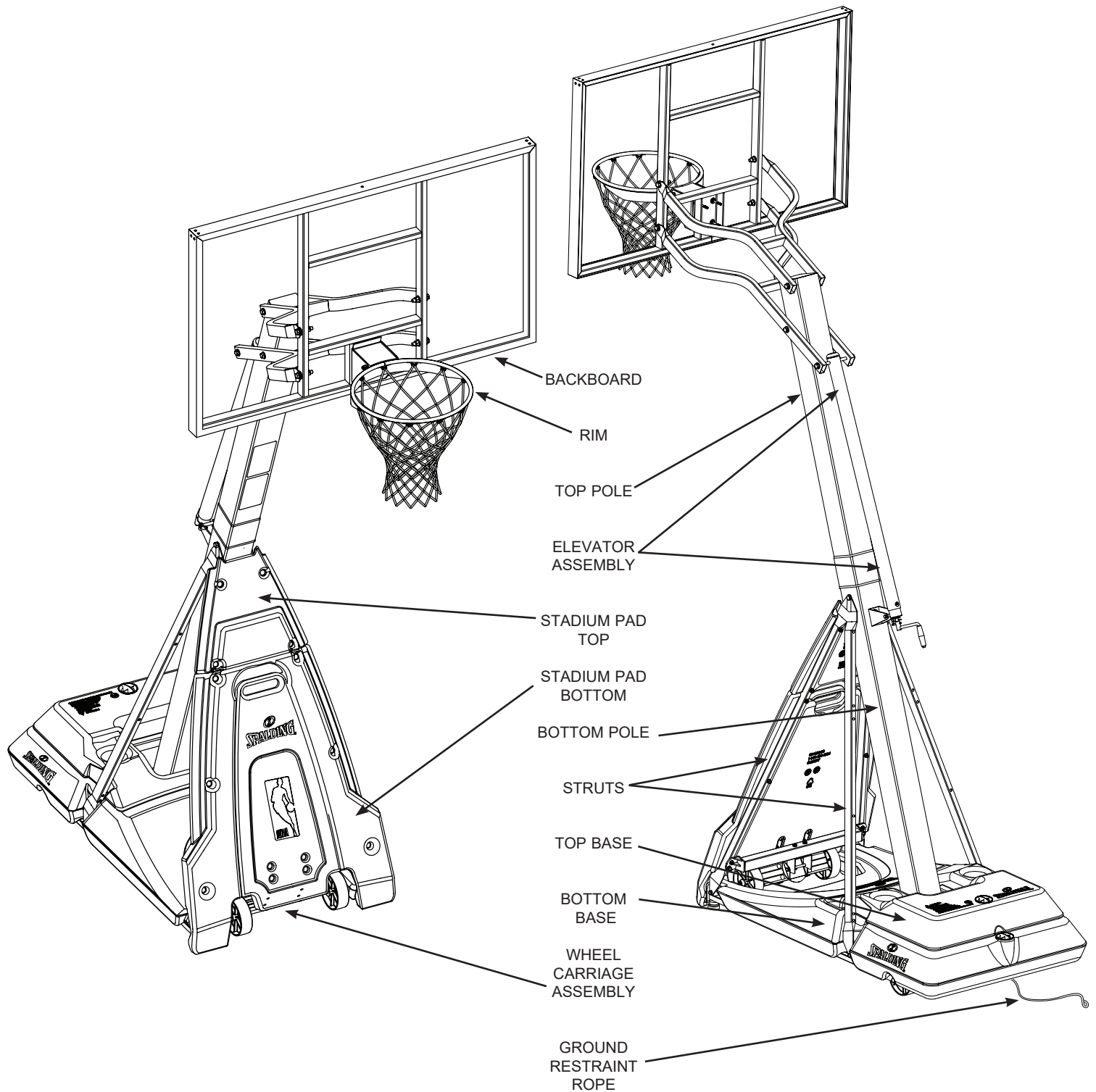

SECTION A: BASE AND POLE ASSEMBLY

BASE TO POLE HARDWARE CARD

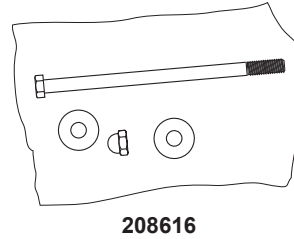
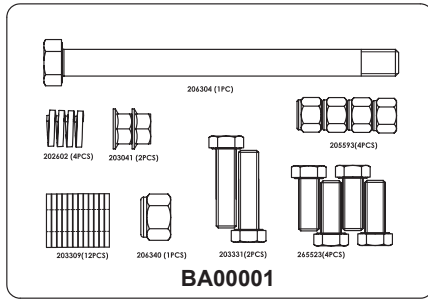

HARDWARE LIST AND IDENTIFIER

<i>Item</i>	<i>Qty.</i>	<i>Part No.</i>	<i>Description</i>	<i>Item</i>	<i>Qty.</i>	<i>Part No.</i>	<i>Description</i>
1	1	600076	Top Base	B4	2	203331	Bolt, Hex Head, 3/8-16 x 1.5" Long
2	1	901183	Bottom Pole Section	B5	4	205593	Lock-nut, Nylon Insert, 3/8-16
3	1	901184	Top Pole Section	B6	1	206340	Lock-nut, Nylon Insert, 1/2-13
4	2	908459	Strut, Front, 62.75" Long, with Holes	B7	4	202602	Lock-washer, 0.375 I.D. x 0.675 O.D.
5	2	908699	Strut, Rear, 62.75" Long	B8	1	206304	Bolt, Hex Head, 1/2-13 x 6-5/16" Long
B1	4	265523	Bolt, Hex Head, 3/8-16 x 1" Long	B9	1	208617	Bolt, Hex Head, 5/16-18 x 5.63 x .91" Long
B2	12	203309	Washer, Flat, 3/8 x 1 O.D.	B10	2	203218	Washer, Flat, 5/16
B3	2	203041	Nut, Hex-Flange, 3/8-16	B11	1	207610	Nut, Acorn, 5/16-18

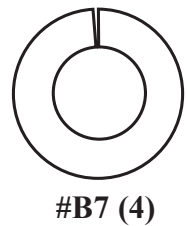
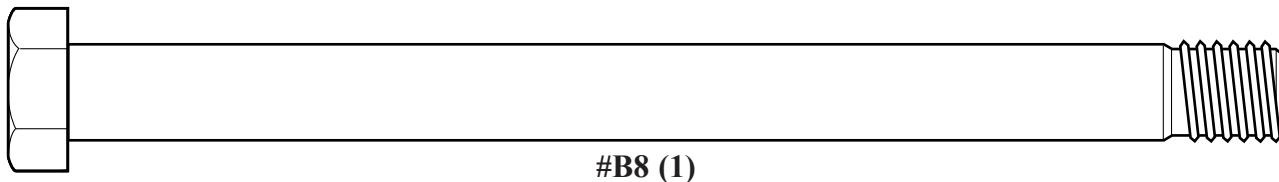
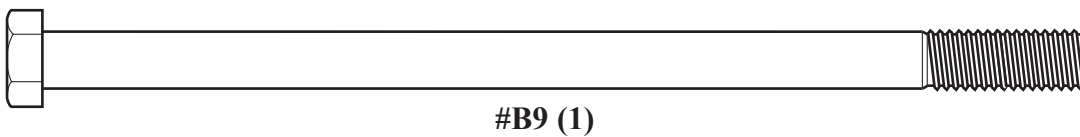
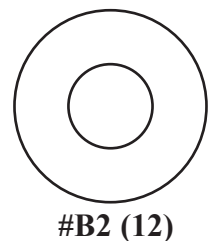
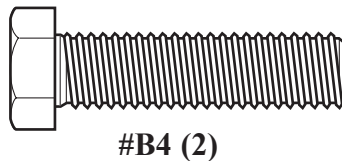
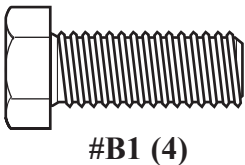
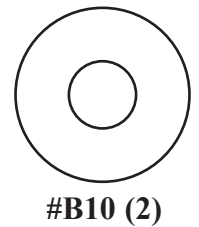
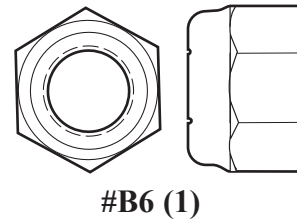
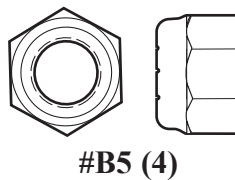
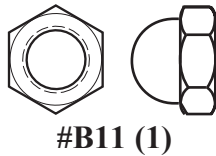
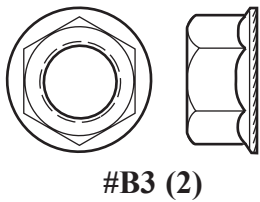

TOOLS REQUIRED FOR THIS SECTION

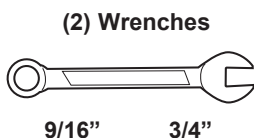

AND/OR

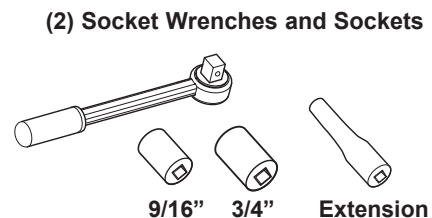

1.



WARNING!

PRE-ASSEMBLED COMPONENTS

The components in steps 1 - 3 are factory pre-assembled.

CHECK THE PRE-ASSEMBLED AREAS FOR TIGHTNESS.

If any parts are missing or damaged please contact our customer service department to receive replacement parts (see page 1 for customer service information).

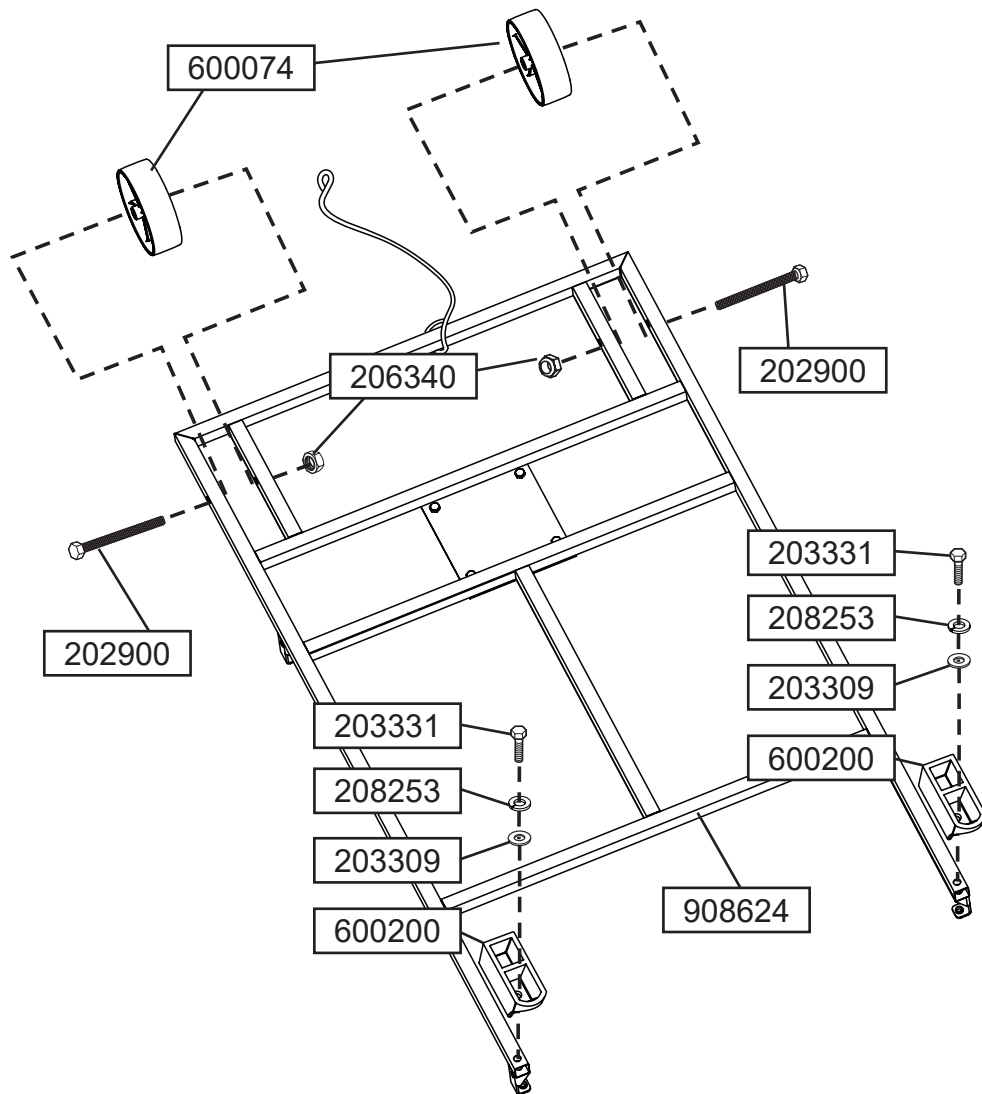

2.

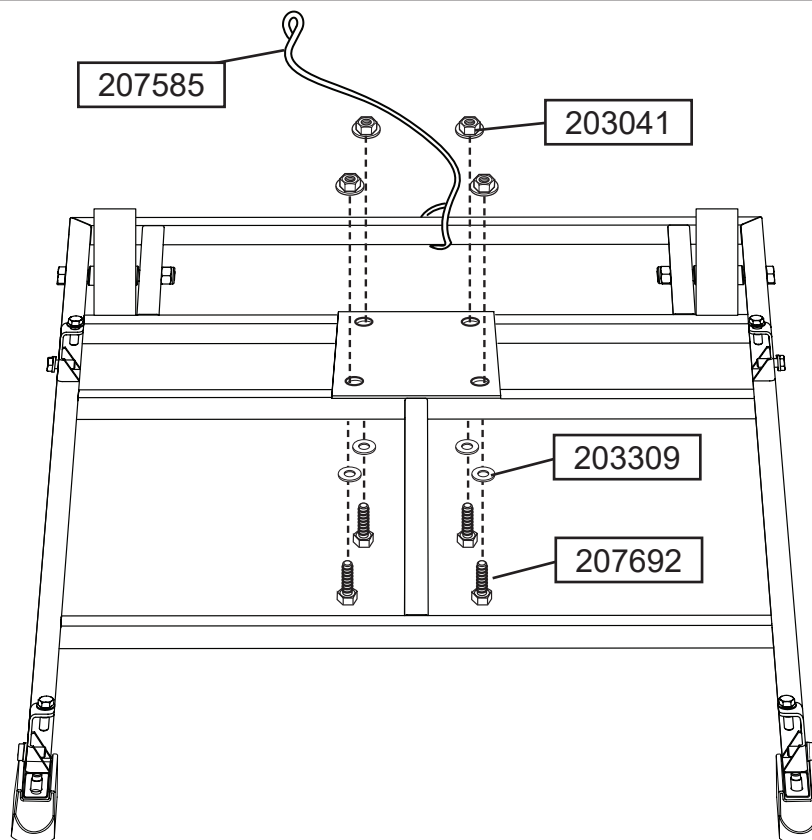

3.

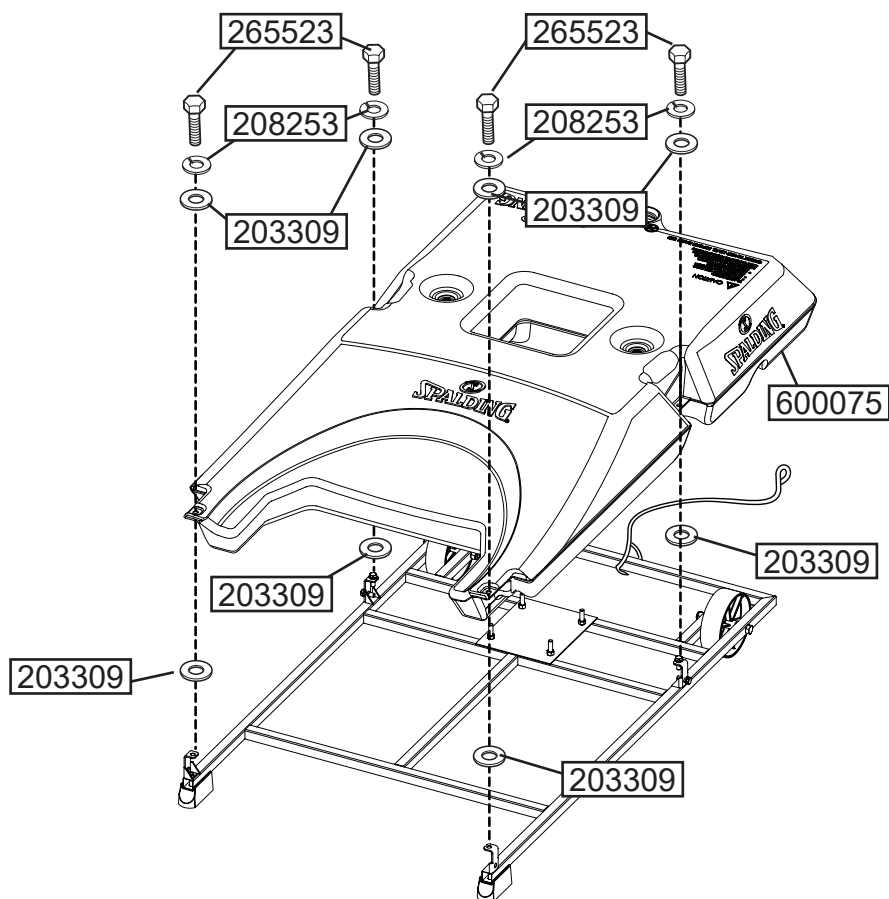

ASSEMBLY REQUIRED

4.

Attach top base (1) to bottom base using bolts (B4), washers (B2) and nuts (B3).

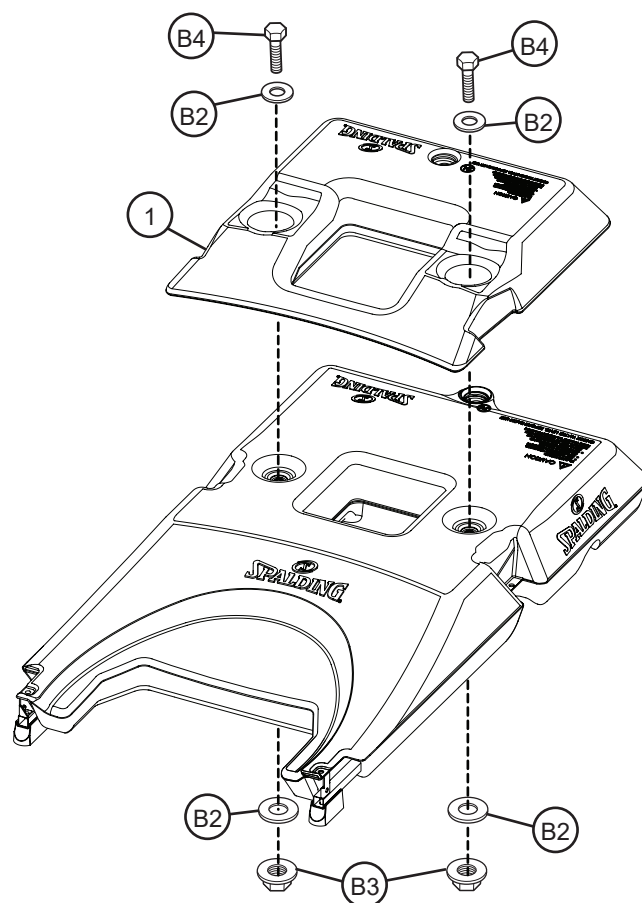

- 5.** Correctly identify each pole section (TOP and BOTTOM). **SEE ILLUSTRATION BELOW.**
NOTE: Please disregard pole identification labels.

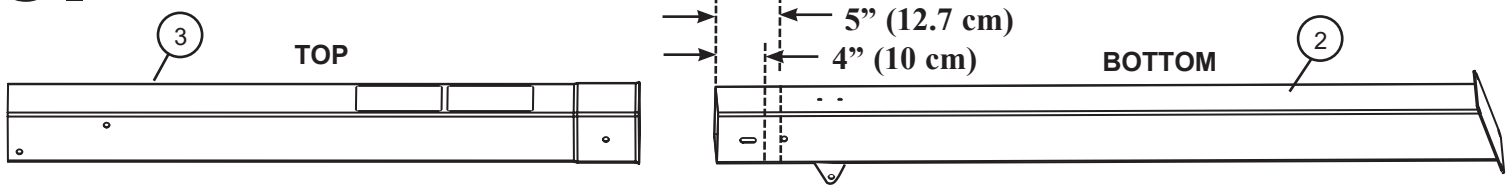

- 6.** Use pencil or tape and mark one line at 4" and one line at 5" from top of bottom pole. **ASSEMBLE TOP POLE TO THE MARKED RANGE OF 4" TO 5".** While maintaining alignment, bounce bottom pole section (2) into top section (3) using a wood scrap as shown. Continue until the top pole (3) has reached the marked range of **4" minimum - 5" maximum** overlap of the bottom pole (2). See **CAUTION!** **NOTE: IF MINIMUM POLE ENGAGEMENT CANNOT BE ACHIEVED !! STOP!! DO NOT PROCEED TO THE NEXT STEP! - CALL SPALDING CUSTOMER SERVICE FOR ASSISTANCE.** When proper range of pole assembly has been achieved, install bolt (B9), washers (B10) and nut (B9) as shown below.



IMPORTANT!

NOTE ORIENTATION OF EACH POLE SECTION.
 Position each pole section so that the **FRONT** and **REAR** faces match the illustration when assembled.
SEE DETAIL VIEWS BELOW



WARNING!

TWO CAPABLE ADULTS REQUIRED FOR THIS PROCEDURE. FAILURE TO FOLLOW THIS WARNING COULD RESULT IN SERIOUS INJURY AND/OR PROPERTY DAMAGE.

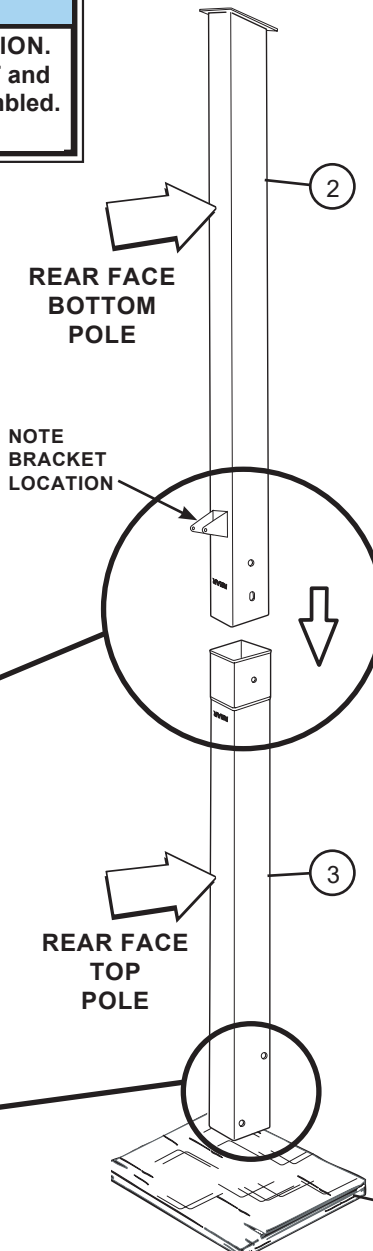
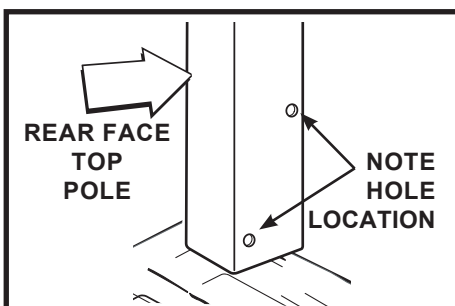
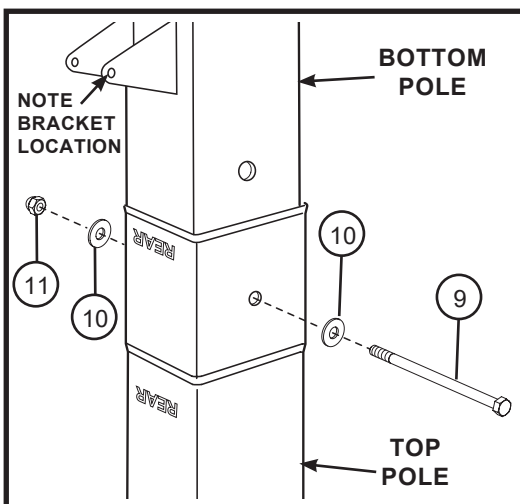

CAUTION!

WHEN PROPERLY ASSEMBLED, THE POLE SECTIONS SHOULD HAVE A **4" MINIMUM TO 5" MAXIMUM** OVERLAP.

FRONT FACE BOTTOM POLE SECTION

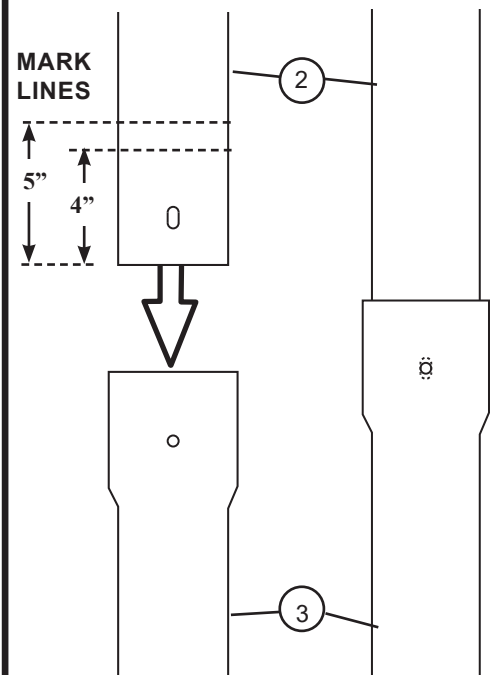

FRONT FACE TOP POLE SECTION

**Wood Scrap - 6" x 6" minimum
 (NOT SUPPLIED)**

Assemble pole to base as shown:

- A.** Place 4 washers (B2) onto the 4 pre-installed bolts so they rest on the nuts.

- B. Rest pole on the 4 washers (B2).**
Allow 4 pre-attached bolts to pass through the 4 holes in bottom pole flange.
Secure pole assembly to plate with washers (B2) and nuts (B5) as shown.

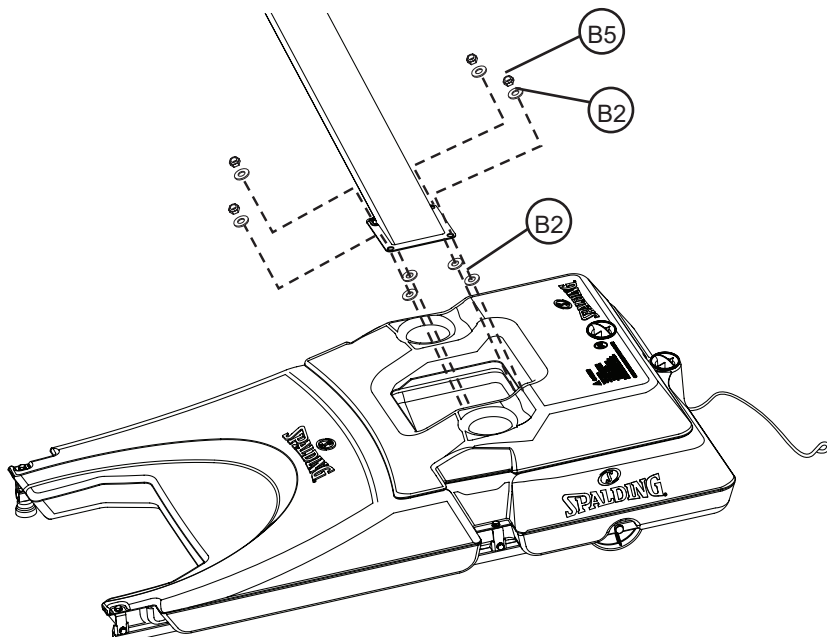

TWO CAPABLE ADULTS REQUIRED FOR THIS PROCEDURE. FAILURE TO FOLLOW THIS WARNING COULD RESULT IN SERIOUS INJURY AND/OR PROPERTY DAMAGE.



The flange of the bottom pole will rest on the nut and washer of frame plate.

Cutaway Views

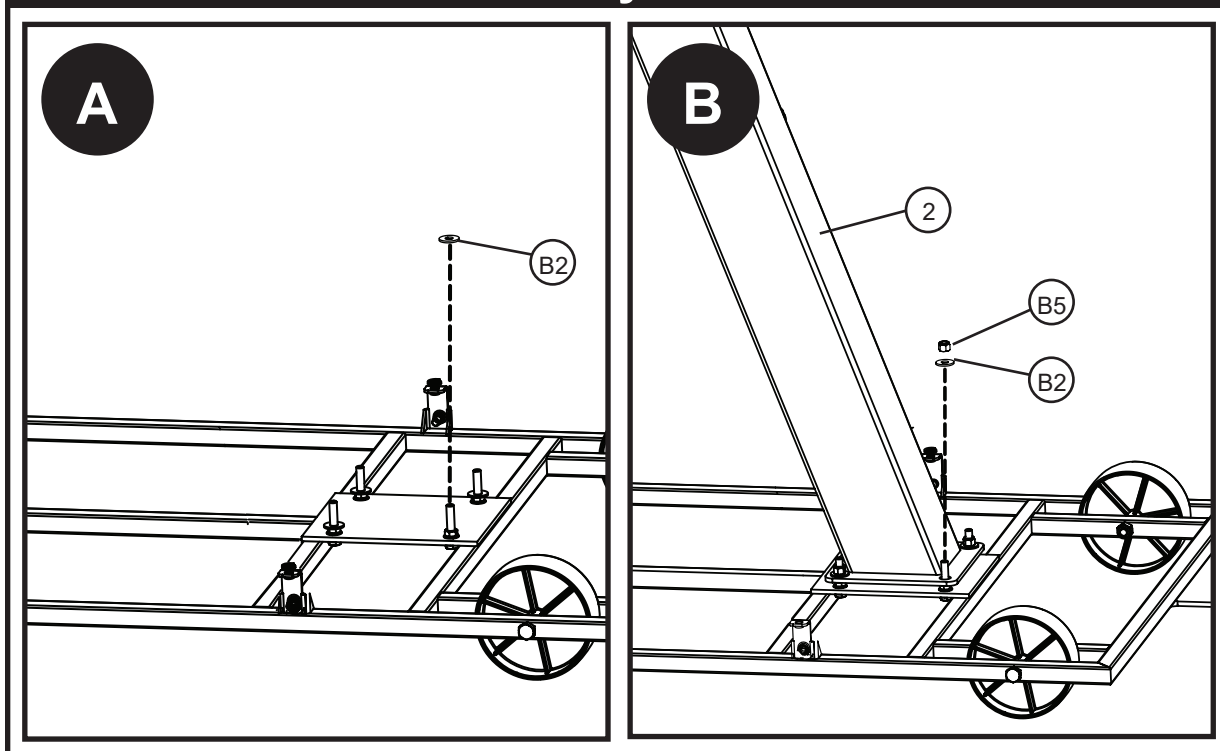

8.

Attach struts (4 and 5) to bottom pole (2) using bolt (B8) and nut (B6).



IMPORTANT!

NOTE POSITION OF STRUTS

Front struts, with holes (4), get placed closest to the pole.



WARNING!

TWO CAPABLE ADULTS REQUIRED FOR THIS PROCEDURE. FAILURE TO FOLLOW THIS WARNING COULD RESULT IN SERIOUS INJURY AND/OR PROPERTY DAMAGE.

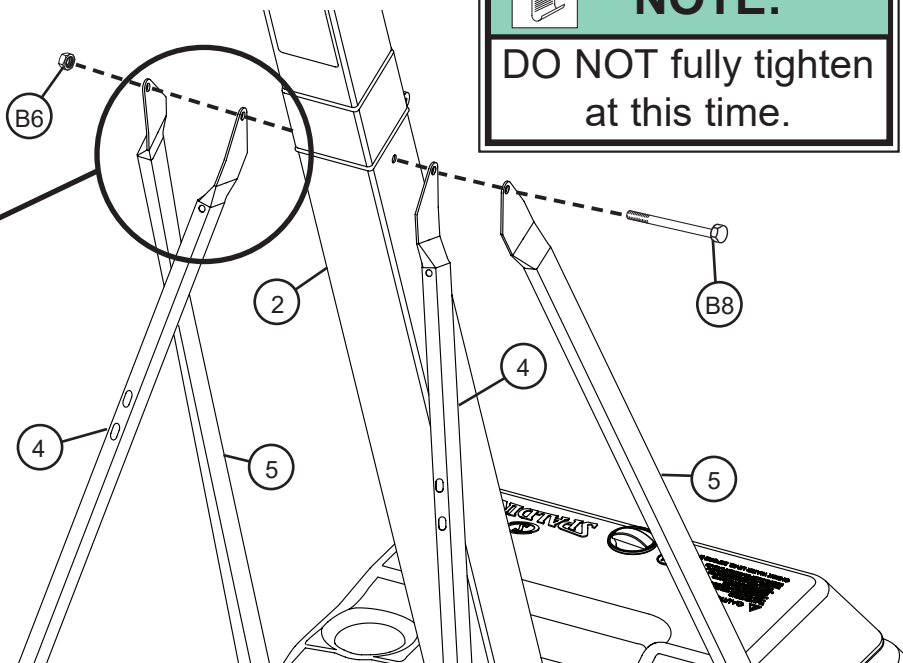

NOTE:

DO NOT fully tighten at this time.

9.

Attach struts (4 and 5) to base frame using bolts (B1) and lock washers (B7).



IMPORTANT!

NOTE ORIENTATION OF STRUTS.

Picture shown is as if you are facing the front of the system.

Front struts (4) have holes in them to attach the stadium pad. The rear struts (5) DO NOT have the holes.

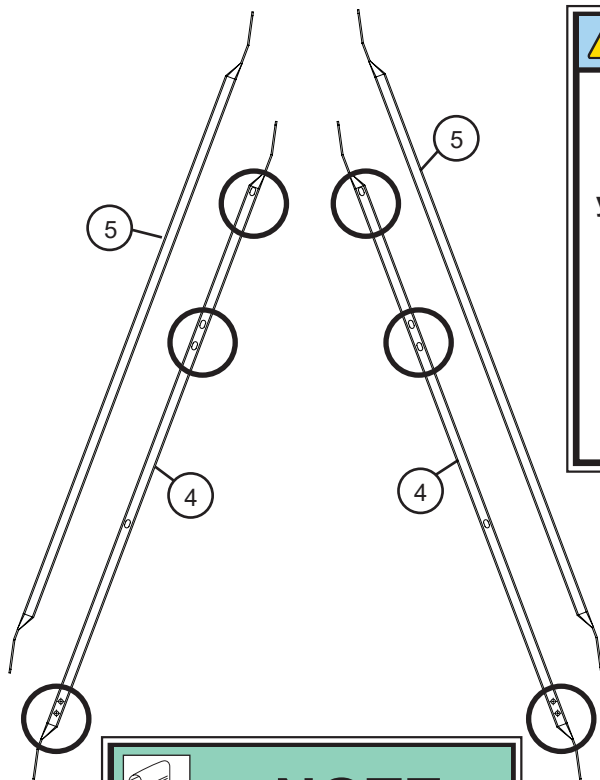

NOTE:

Fully tighten all hardware in step 8 and 9 at this time.

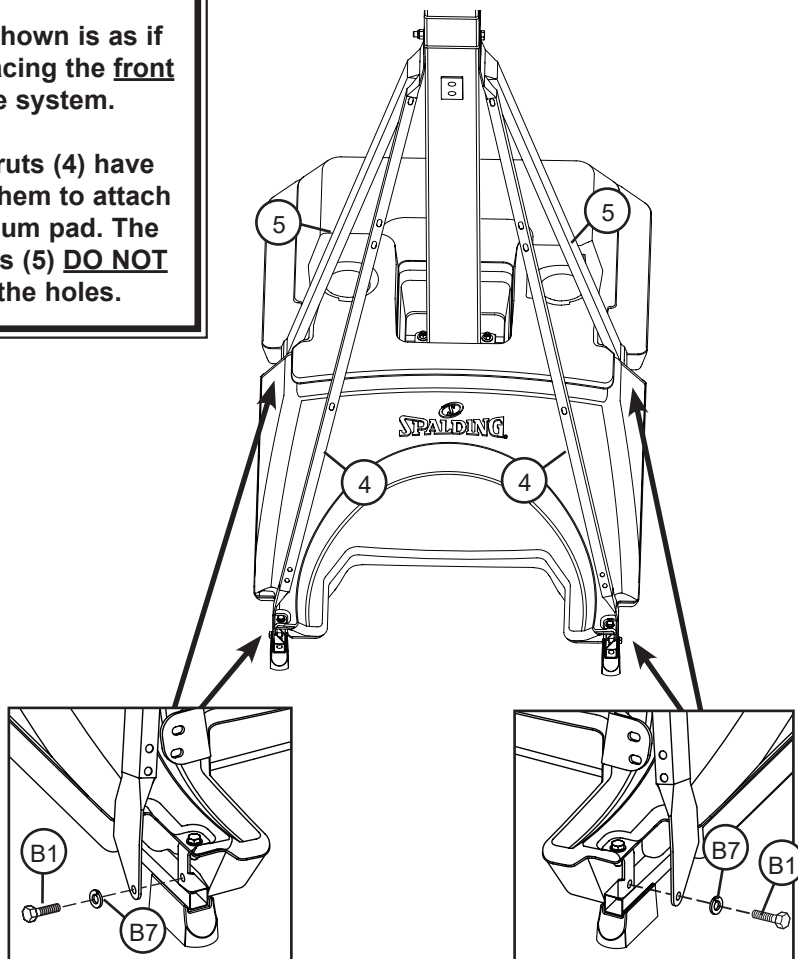

SECTION B: WHEEL CARRIAGE ASSEMBLY

FRONT WHEEL ASSEMBLY HARDWARE CARD

TOOLS REQUIRED FOR THIS SECTION

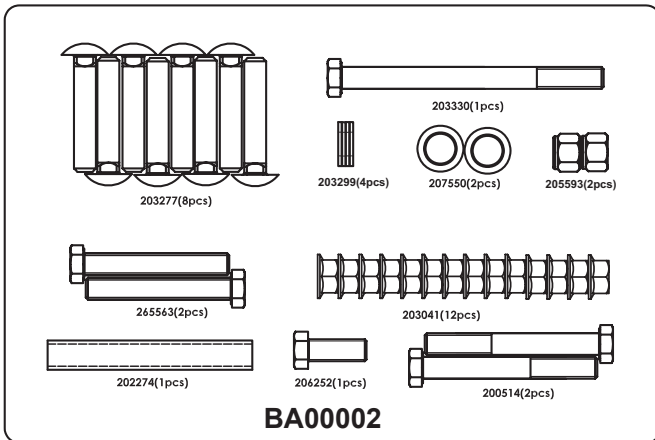

(2) Wrenches



9/16"

AND/OR

(2) Socket Wrenches and Sockets

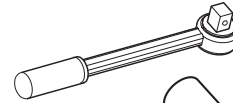

9/16"

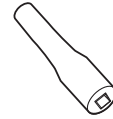

Extension

HARDWARE LIST AND IDENTIFIER

<u>Item</u>	<u>Qty.</u>	<u>Part No.</u>	<u>Description</u>	<u>Item</u>	<u>Qty.</u>	<u>Part No.</u>	<u>Description</u>
10	2	600074	Wheel, 6"	W2	12	203041	Nut, Hex-Flange, 3/8-16
11	1	600079	Transport Handle, Plastic	W3	4	203299	Washer, 3/8 Flat
12	1	800373	U-Bracket, Pivot	W4	2	265563	Bolt, Hex Head, 3/8-16 x 2.5" Long
13	1	908466	Bracket, Wheel	W5	1	203330	Bolt, Hex Head, 3/8-16 x 4.5" Long
14	1	206948	Bracket, Pivot, Lower	W6	2	205593	Lock-Nut, 3/8-16
15	1	206956	Disk, Pivot, Plastic	W7	1	206252	Bolt, Hex Head, 3/8-16 x 1" Long
16	1	908513	Cross Member	W8	8	203277	Bolt, Carriage, 3/8-16 x 2"
17	1	206082	Axle, Rod, 20.5" Long	W9	2	207550	Push Caps, Metal, Wheel Assembly
18	2	908460	Tube, Hinged	W10	1	202274	Spacer, 0.379 I.D. x 0.50 O.D. x 3.5" Long
W1	2	200514	Bolt, Hex Head, 3/8-16 x 3" Long				

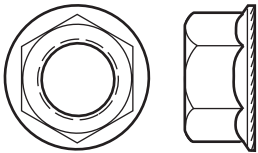

#W2 (12)

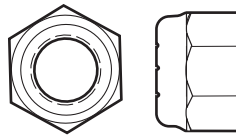

#W6 (2)

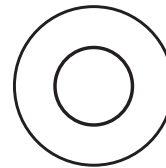

#W3 (4)

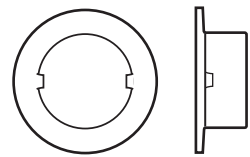

#W9 (2)

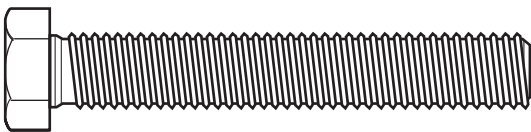

#W4 (2)

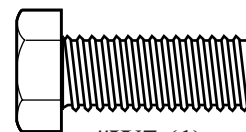

#W7 (1)

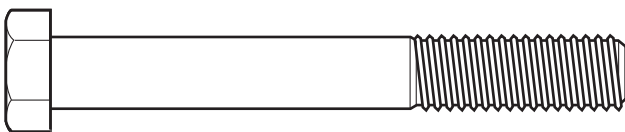

#W1 (2)



#W10 (1)

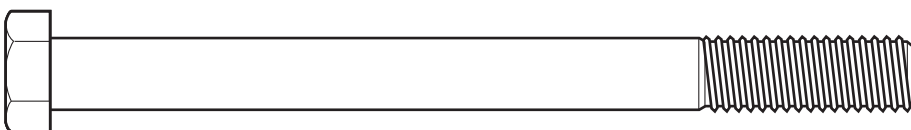

#W5 (1)



#W8 (8)

1.

A. Attach u-bracket (12) to cross member (16) using bolts (W4), washers (W3) and nuts (W2).

B. Secure cross member (16) to front struts (4) using bolts (W1), washer (W3) and nuts (W2)

A

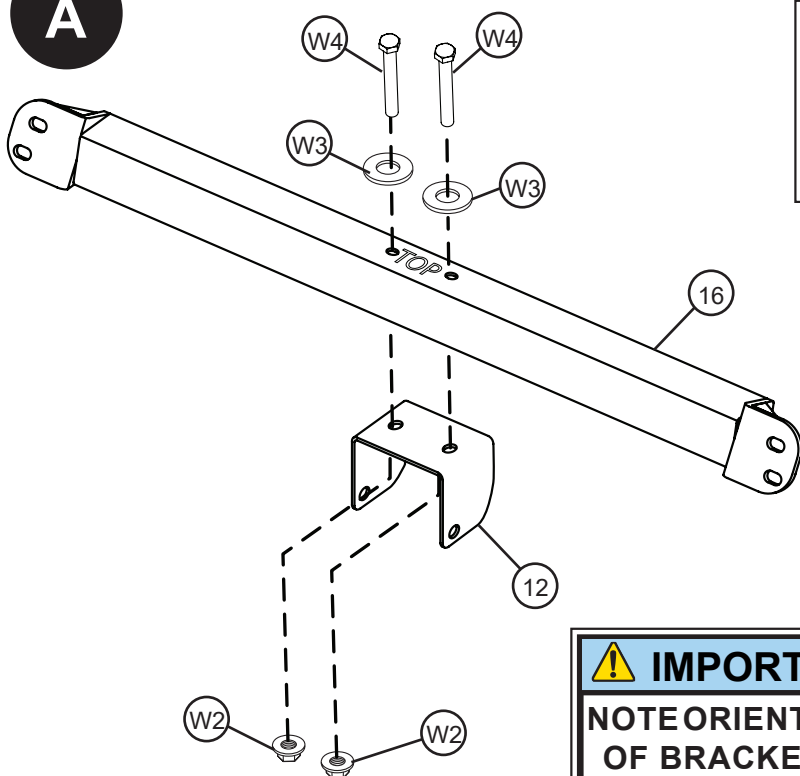

! IMPORTANT!
NOTE ORIENTATION
OF STRUT BRACE (16).

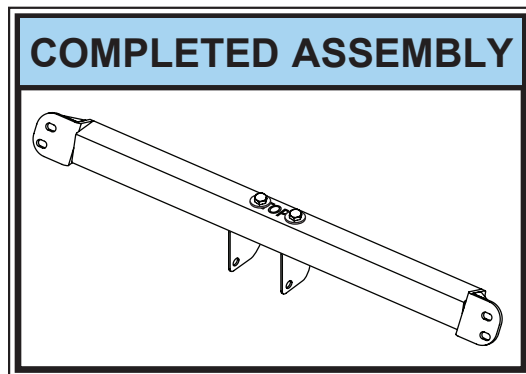

! IMPORTANT!
NOTE ORIENTATION
OF BRACKET (12).

B

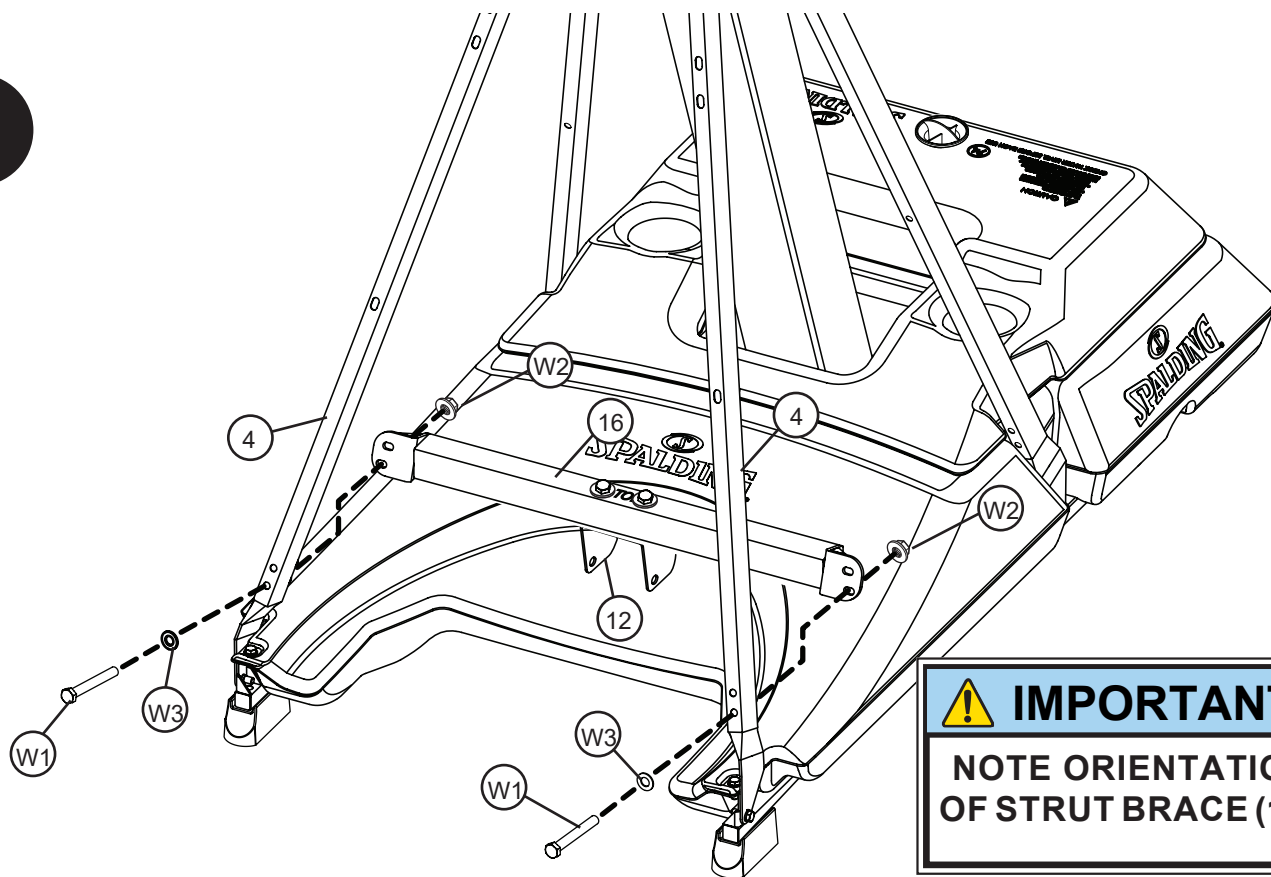

! IMPORTANT!
NOTE ORIENTATION
OF STRUT BRACE (16).

- 2.** Insert axle (17) through wheel bracket (13). Secure wheels (10) to axle using pushnuts (W9). Carefully tap pushnuts (W9) onto axle with hammer or mallet.

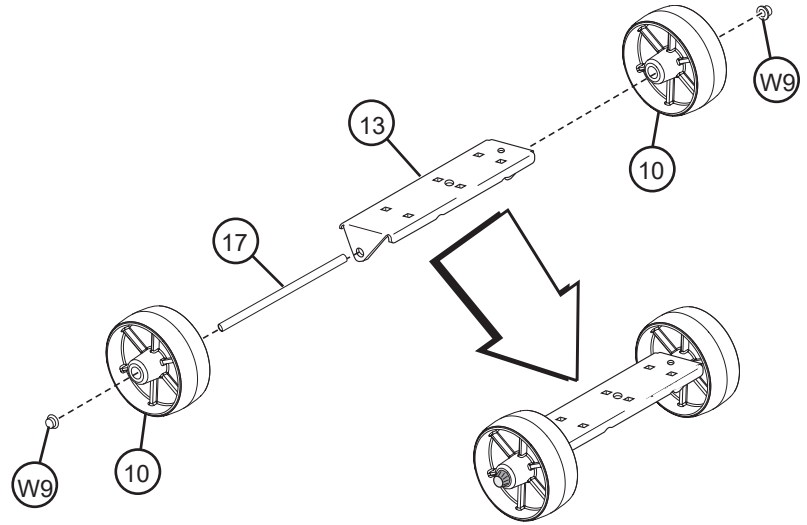
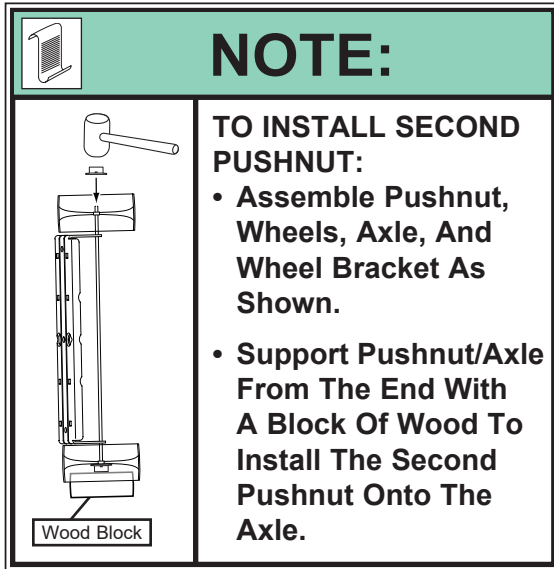

- 3.** Secure hinge tubes (18) to wheel bracket (13) using bolts (W8), and nuts (W2).

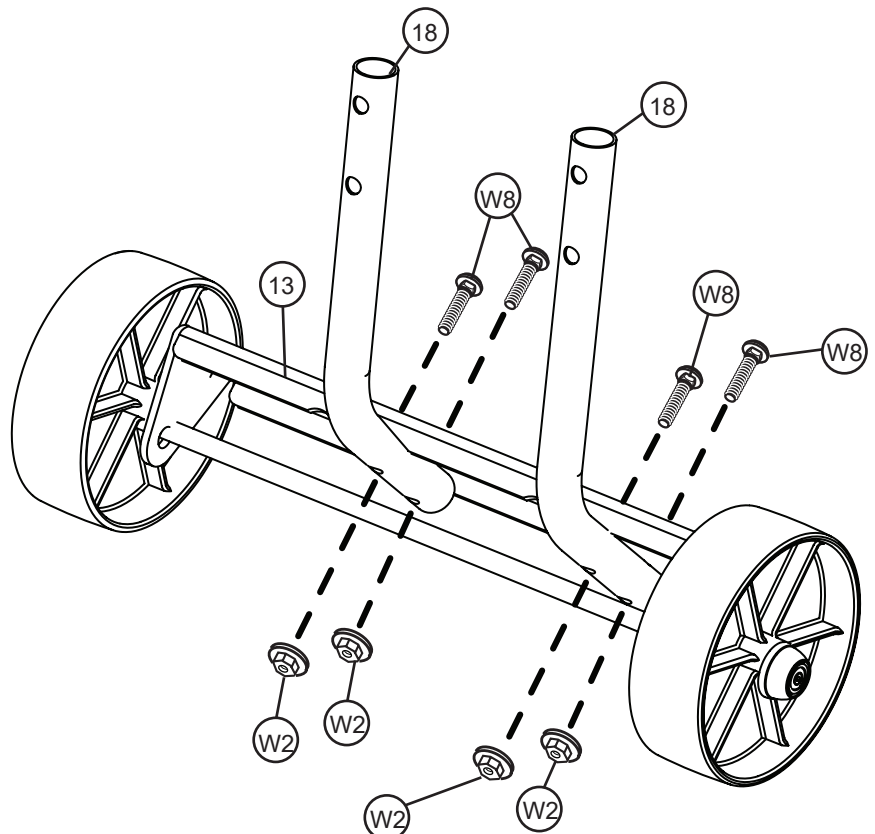
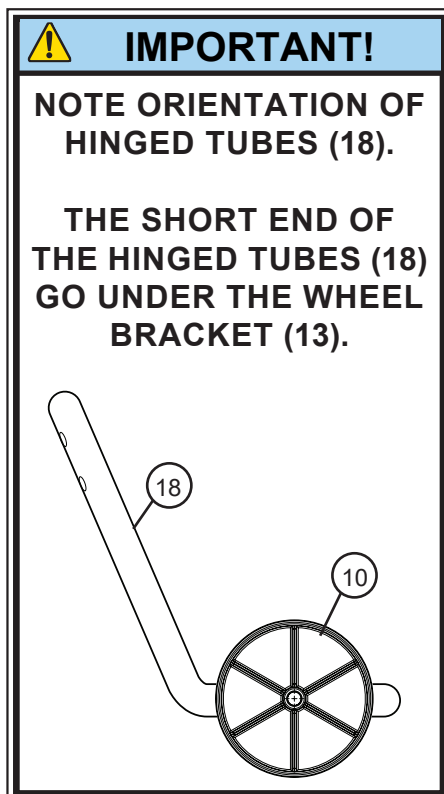

- 4.** Secure lower pivot bracket (14) to wheel assembly using bolt (W7), pivot disk (15) and nut (W6). Secure wheel assembly to u-bracket (12) using bolt (W5), spacer (W10), and nut (W6).

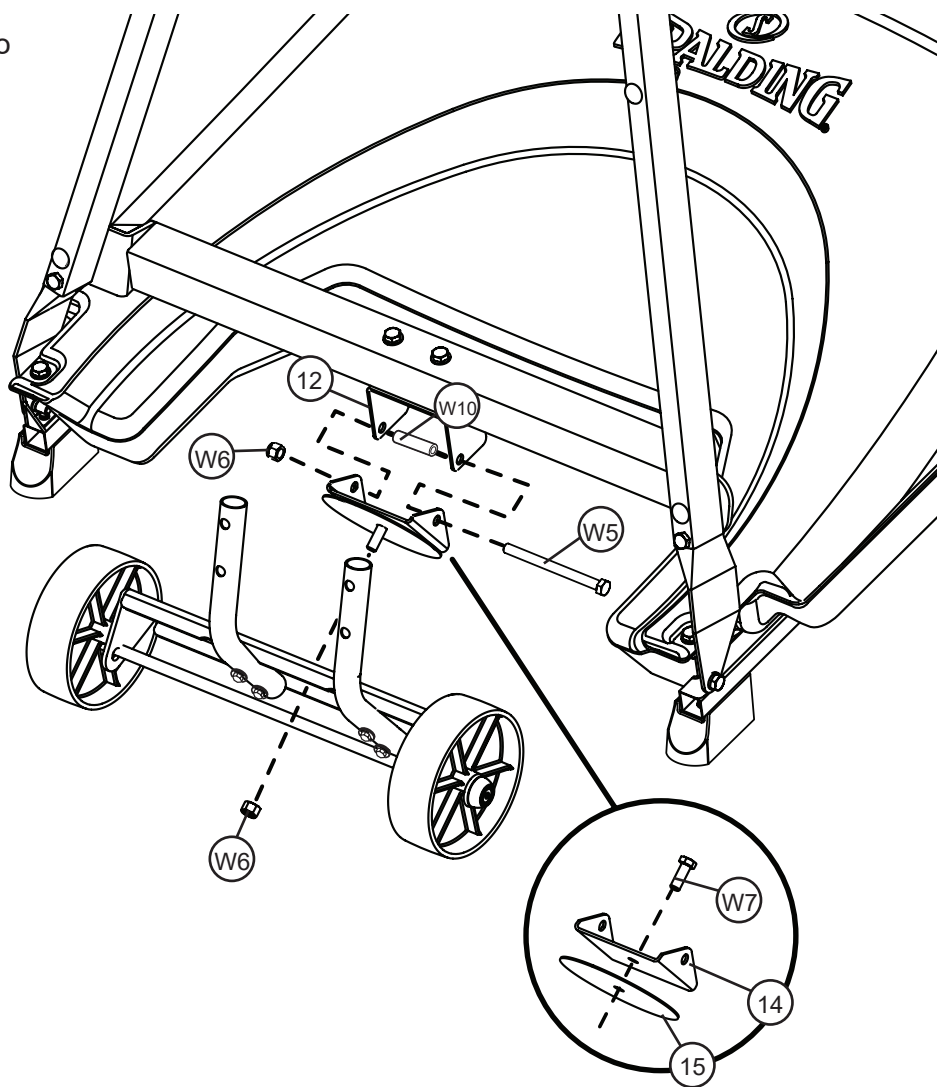
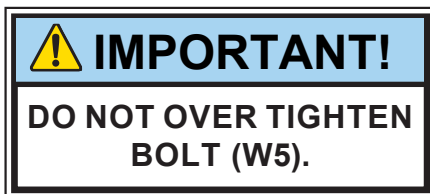

- 5.** Attach transport handle (11) to wheel assembly using carriage bolts (W8) and nuts (W2).

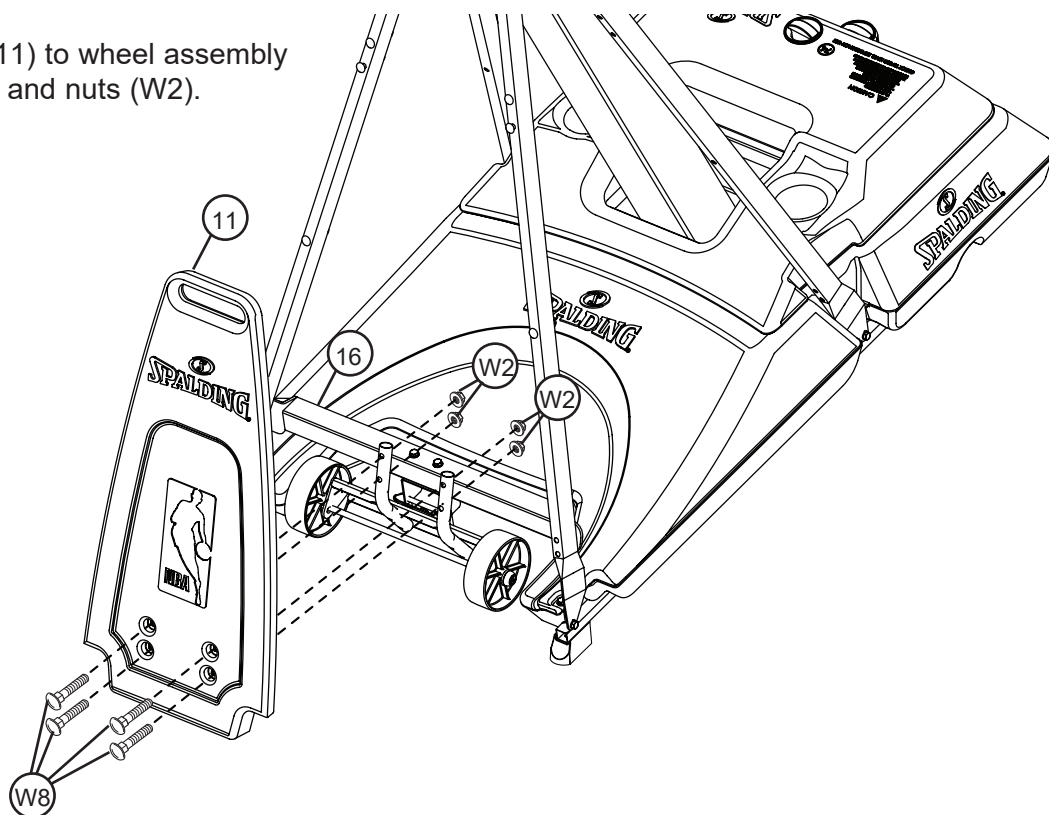

SECTION C: ELEVATOR ASSEMBLY PART 1

ELEVATOR TO POLE CONNECTION HARDWARE CARD

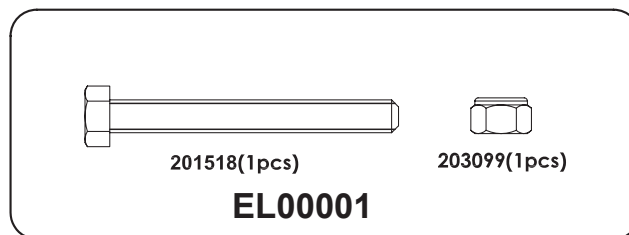

HARDWARE LIST AND IDENTIFIER

<u>Item</u>	<u>Qty.</u>	<u>Part No.</u>	<u>Description</u>	<u>Item</u>	<u>Qty.</u>	<u>Part No.</u>	<u>Description</u>
20	1	700009	Handle, Screw-Jack	24	1	202528	Pin, Handle
21	1	80034403	Screw Jack	E1	1	201518	Bolt, Hex-Head, 5/16-18 x 2.75" Long
22	1	60016401	Sleeve, Screw Jack	E2	1	203099	Lock-Nut, Nylon Insert, 5/16-18
23	1	600165	Cap, Screw Jack				

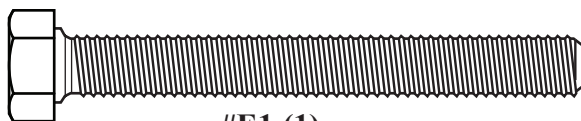

#E1 (1)

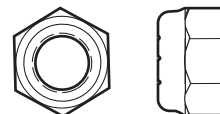

#E2 (1)

TOOLS REQUIRED FOR THIS SECTION

(2) Wrenches



1/2"

AND/OR

(2) Socket Wrenches and Sockets

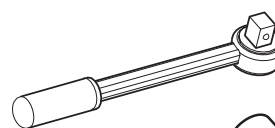

1/2"

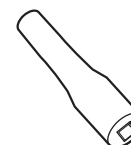

Extension

Hammer or Mallet

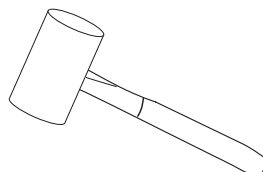

1.

A. Securely rest the assembly on sawhorse.

B. Slide screw-jack sleeve (22) over screw jack and attach cap (23) to top end.

C. Attach screw-jack (21, 22, 23) to pole bracket with bolt (E1) and nut (E2) as shown.

D. Attach handle (20) to screw jack with pin (24).

A

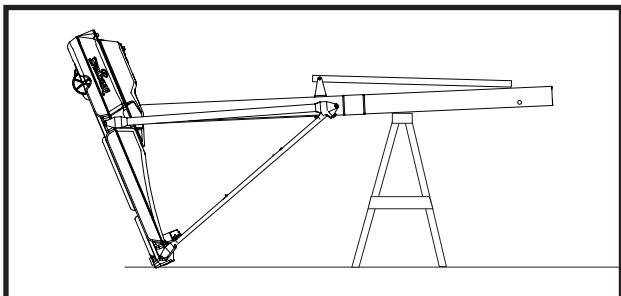

B

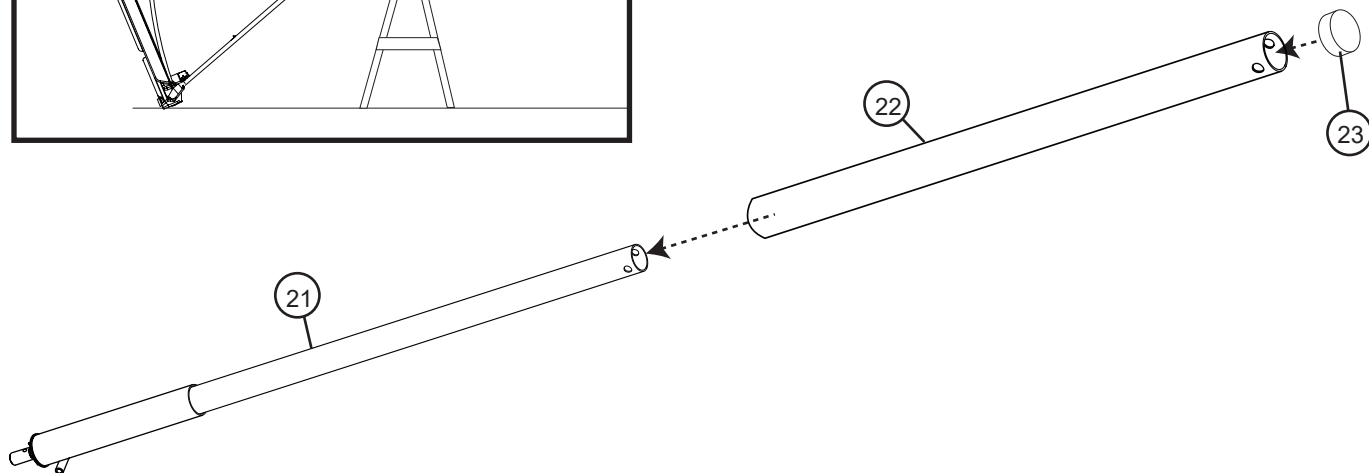

C

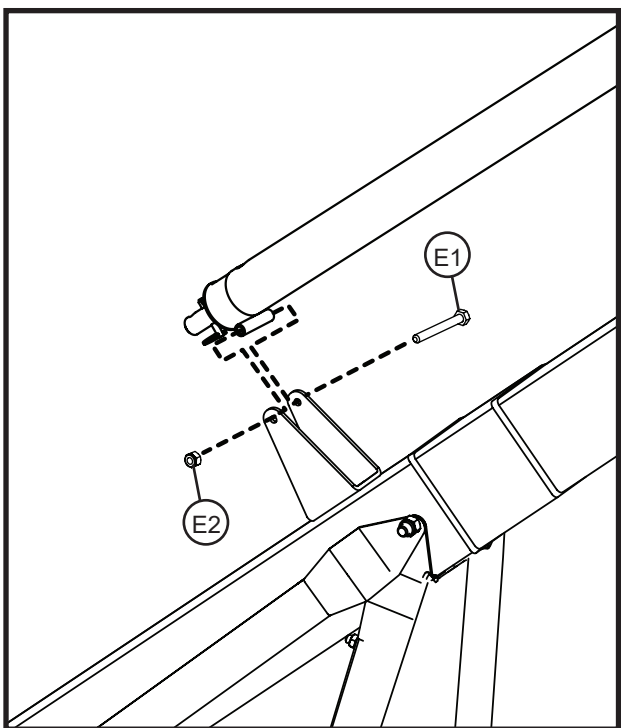

D

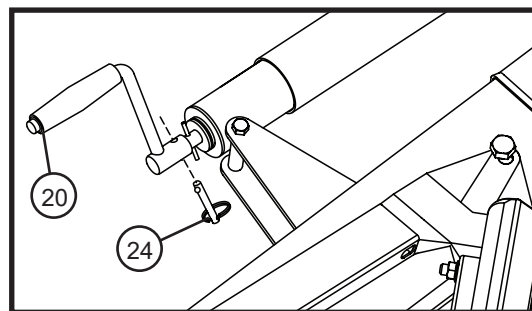

SECTION D: ELEVATOR ASSEMBLY PART 2

ELEVATOR ARMS HARDWARE CARD

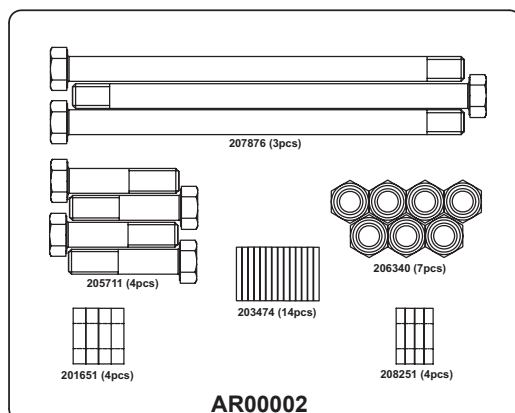

TOOLS REQUIRED FOR THIS SECTION

(2) Wrenches



3/4"

AND/OR

(2) Socket Wrenches and Sockets

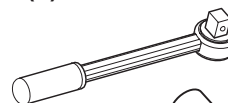

3/4"



Extension

HARDWARE LIST AND IDENTIFIER

<u>Item</u>	<u>Qty.</u>	<u>Part No.</u>	<u>Description</u>
30	1	908508	Elevator Tube, Upper
31	1	908509	Elevator Tube, Lower
32	1		Backboard
33	2	700012	Plug Cap
34	4	208482	Spacer, Steel 0.50" I.D. x 0.875" O.D. x 0.465" Long
35	1	20755201	Pad, Foam

<u>Item</u>	<u>Qty.</u>	<u>Part No.</u>	<u>Description</u>
A1	4	205711	Bolt, Hex-Head, 1/2-13 x 2.25" Long
A2	7	206340	Nut, Nylock, 1/2-13
A3	14	203474	Washer, Flat, 1.08" O.D.
A4	4	201651	Bushing, Plastic, 0.50" I.D. x 0.25" Long
A5	3	207876	Bolt, Hex-Head, 1/2-13 x 8.4" Long
A6	4	208251	Bushing, Plastic, 0.50" I.D. x 0.13" Long

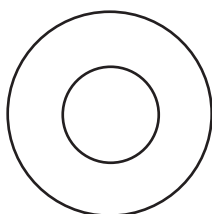

#A3 (14)

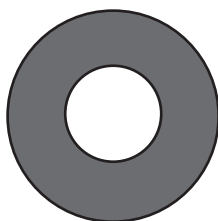

#A4 (4)

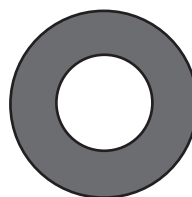

#A6 (4)

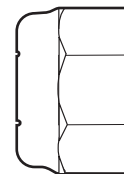
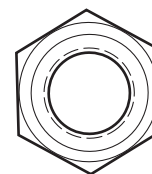

#A2 (7)

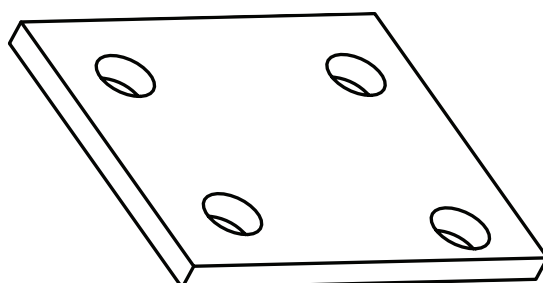

#35 (1)



#34 (4)

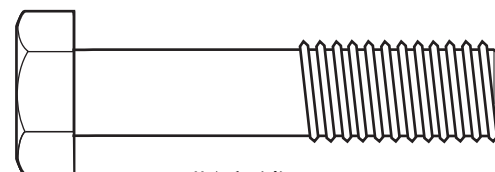

#A1 (4)

- 1.** While system is still resting on sawhorse, Identify elevator tubes (30 and 31).

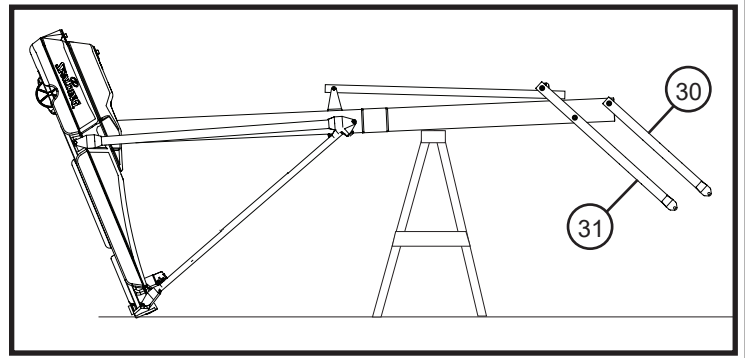
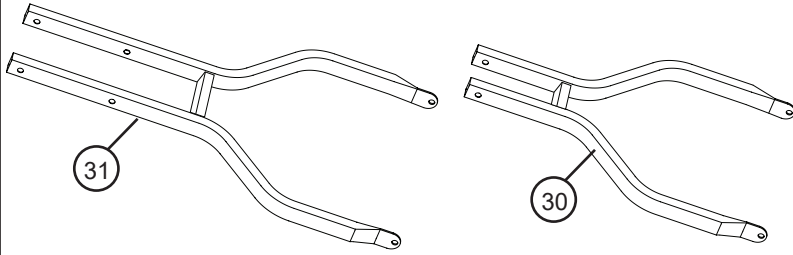

- 2.** While the system is securely resting on the sawhorse. Install elevator tubes (30 and 31) to top pole section (3) as shown.

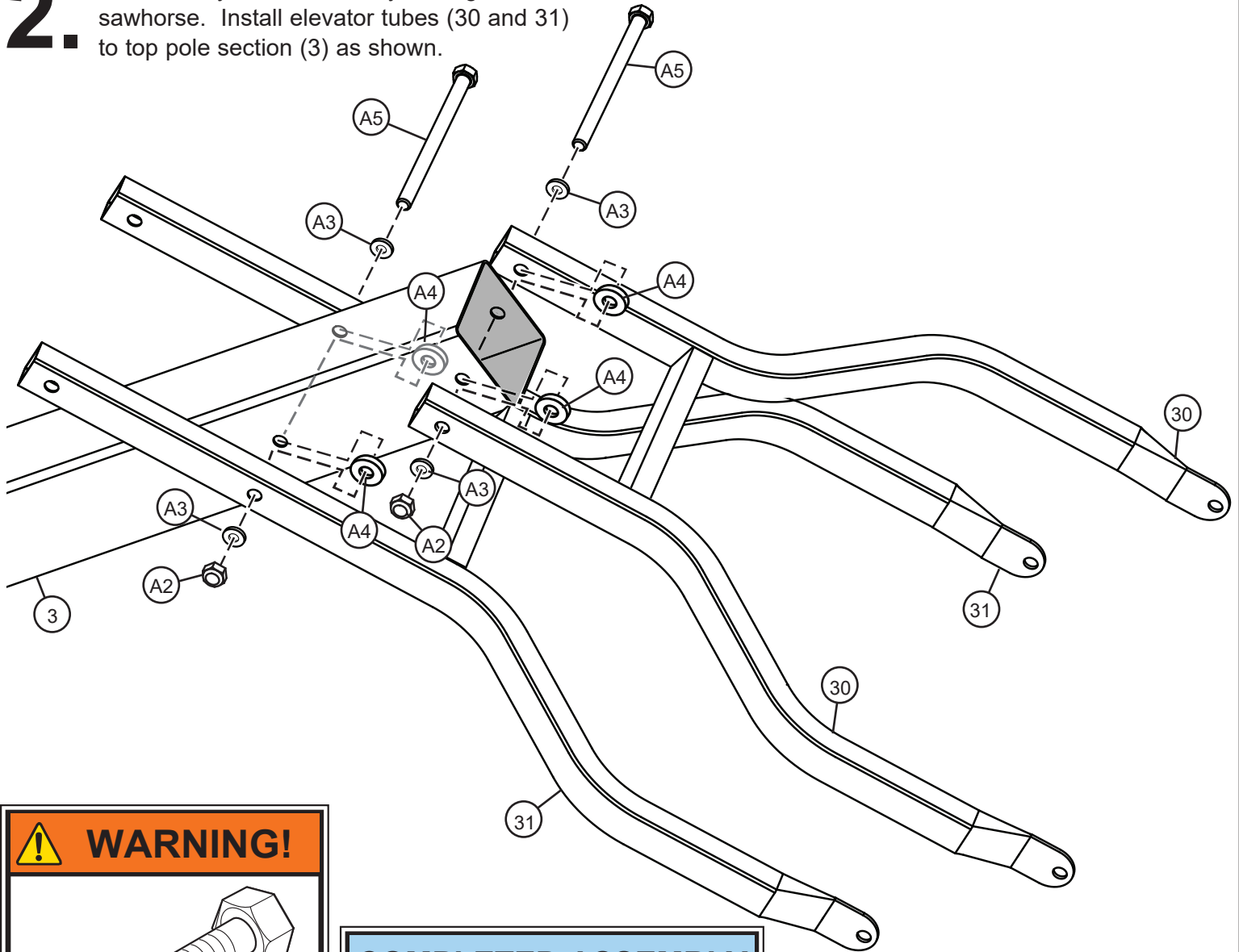

WARNING!

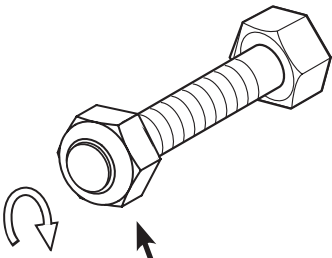

TIGHTEN BOLT (A5) IN LOCK NUT (A2) UNTIL FLUSH (EVEN) WITH LOCK NUT'S OUTER EDGE.

COMPLETED ASSEMBLY

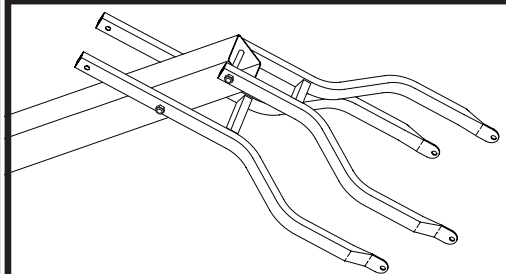

WARNING!

TWO CAPABLE ADULTS REQUIRED FOR THIS PROCEDURE. FAILURE TO FOLLOW THIS WARNING COULD RESULT IN SERIOUS INJURY AND/OR PROPERTY DAMAGE.

IMPORTANT! - IMPORTANT! - WICHTIG! - ¡IMPORTANTE!

Instructions for GLASS BACKBOARD - ONLY!

Instructions pour le verre panneau - UNIQUEMENT !

Anweisungen für Glas RÜCKWAND - NUR!

Instrucciones de VIDRIO TABLERO - SÓLO!



WARNING! AVERTISSEMENT! WARNUNG! ¡ADVERTENCIA!



PLEASE ENSURE that foam pad and all 4 steel spacers are in position **BEFORE** attaching yokes.
Failure to follow these instructions could result in personal injury or damage to property.

VEUILLEZ VOUS ASSURER que la mousse pad et tous les 4 entretoises en acier sont en position **AVANT** de fixer les chapes.
Le non-respect de ces instructions peut entraîner des blessures ou des dommages à la propriété.

BITTE STELLEN SIE SICHER dass Schaumstoff und alle 4 Distanzstücke aus Stahl sind in Position befindet **BEVOR** mit der installation gabeln.
Bei Nichtbeachtung dieser Anweisungen kann zu Verletzungen oder Schäden an Eigentum.

POR FAVOR, ASEGÚRESE de que almohadilla de espuma y los 4 separadores de acero están en su posición correcta **ANTES** de conectar las horquillas.
El incumplimiento de estas instrucciones puede resultar en lesiones personales o daños a la propiedad.

1. Place foam pad on flat surface with adhesive side facing up and remove protective film.
Placez le coussinet en mousse sur une surface plane, côté adhésif vers le haut et retirez le film protecteur.
Setzen Sie den Schaumstoff auf einer ebenen Fläche mit der Klebeseite nach oben und entfernen Sie die Schutzfolie.
Coloque la almohadilla de espuma sobre una superficie plana con adhesivo en el lado hacia arriba y retirar la película protectora.
2. Individually align (4) steel spacers with the (4) holes of the foam pad and firmly press the spacers onto the adhesive of foam pad.
Individuellement aligner (4) entretoises en acier avec les (4) trous de la mousse et appuyez fermement sur les entretoises sur l'adhésif de protection en mousse.
Individuell ausrichten (4) Distanzstücke aus Stahl mit den (4) Löcher an den Schaumstoff und drücken Sie fest auf den Distanzstücken auf den Kleber von schaumstoff.
Alinear individualmente (4) separadores de acero con las (4) orificios de la almohadilla de espuma y presione firmemente los espaciadores en el adhesivo de la almohadilla de espuma.
3. Align (4) steel spacers from the spacer and foam pad assembly from step 2 into mounting holes on backboard and firmly press into position.
Aligner (4) entretoises en acier provenant de la pièce d'écartement et mousse assemblé à l'étape 2 dans les trous de fixation sur panneau et appuyez sur chambre croit fermement en position.
Richten Sie (4) Distanzstücke aus Stahl aus dem Distanzstück und Schaumstoffpolster aus Schritt 2 in die Befestigungsbohrungen auf Rückwand und irmly drücken Sie sie in Position.
Alinear (4) separadores de acero por el separador y la almohadilla de espuma del paso 2 asamblea en los agujeros de montaje en tablero y irmly pulse en su posición.

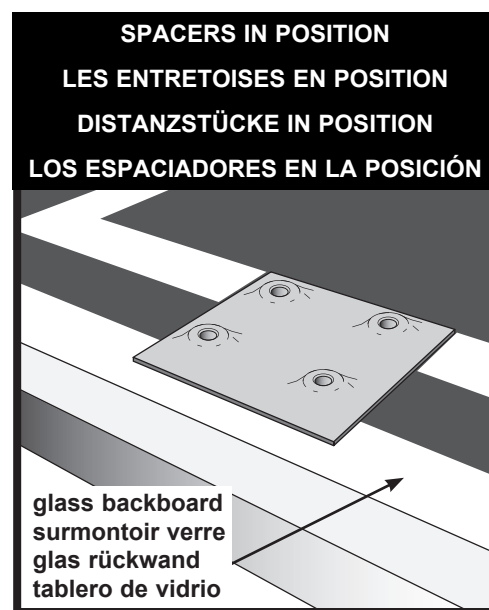
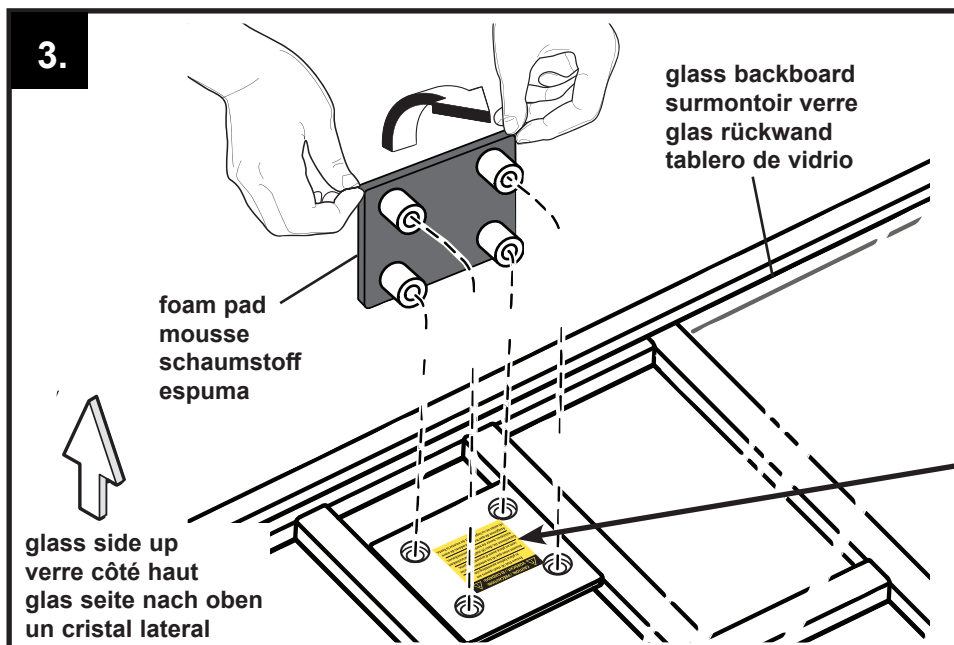
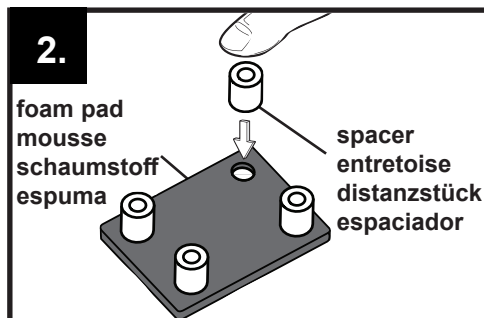
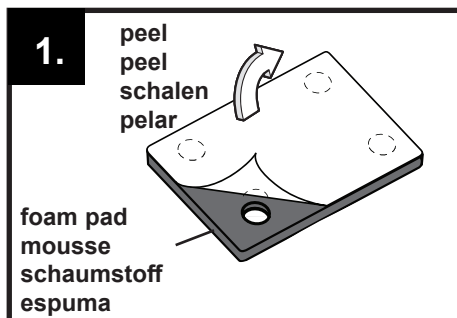

CAUTION: / PRÉCAUTION: VORSICHT: / EI CUIDADO:

Ensure that (4) steel spacers are in place before assembling rim.

Assurez-vous que (4) les entretoises d'acier sont en place avant d'assembler la jante.

Garantieren sie, dass (4) stahl-distanzscheiben existieren, bevor sie kante zusammenbauen.

Asegúrese de que los espaciadores de acero (4) están en su lugar antes de montar la llanta.

12/12 P/N 500046

- 3.** While the system is still resting on the sawhorse, making sure to align both the inner metal screw-jack (21) AND the outer plastic screw-jack sleeve (22) bolt holes and install screw jack assembly to lower elevator tube (31). Secure with bolt (A5), washers (A3) and nut (A2). Re-install screw-jack cap (23).

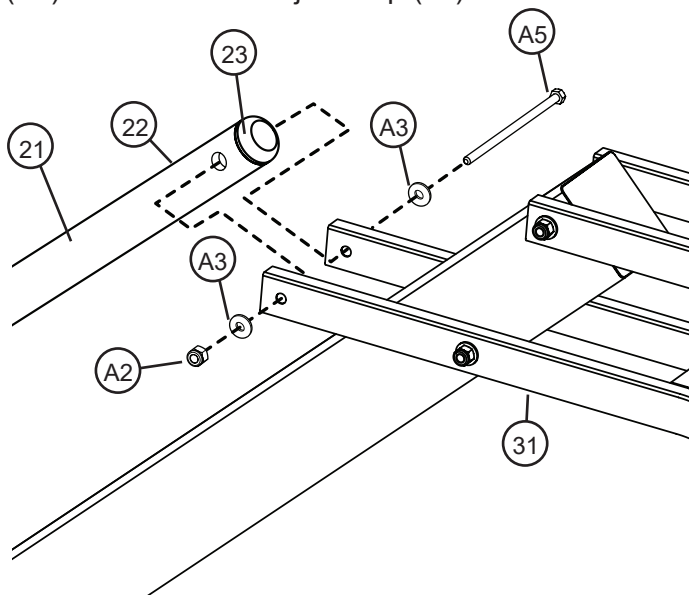
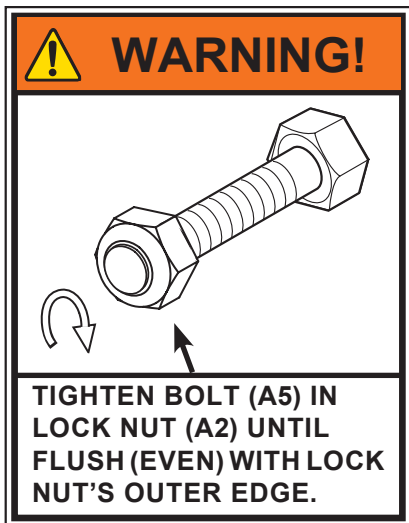

- 4.** Attach backboard (32) to elevator tubes as shown.

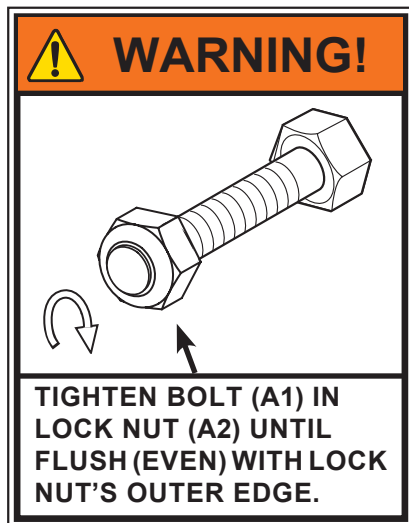
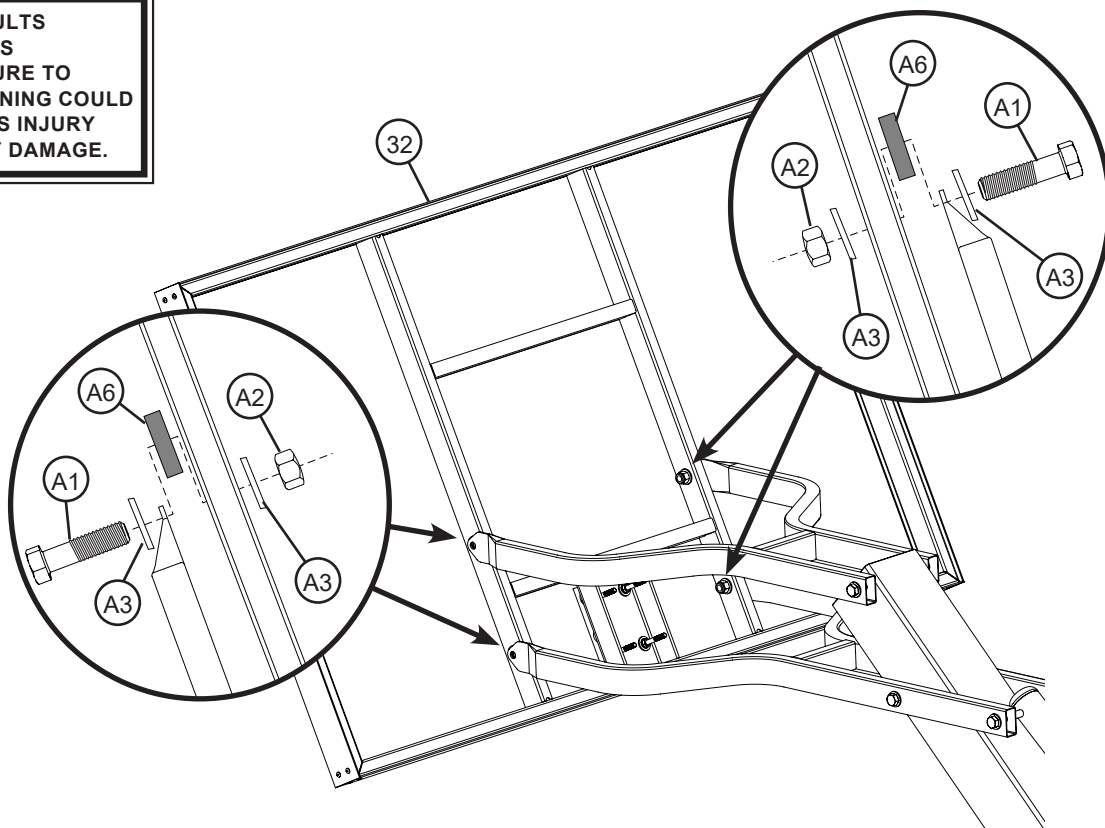
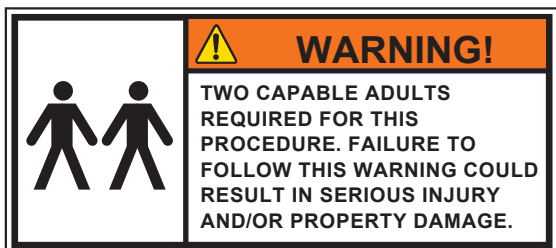

- 5.**
- A. Fill bottom base half-way with water (approx. 25 gallons (95 Liters)) or sand (approx. 295 of total 590 lbs. (134 of total 268 kg)).
 - B. Set backboard to the **LOWEST** elevator setting
 - C. **CAREFULLY** upright system.

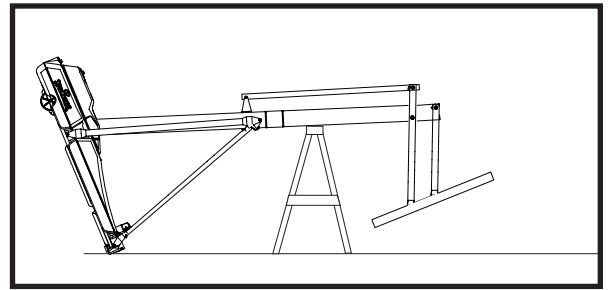

NOTE:

Make sure that the anchor rope is centered.

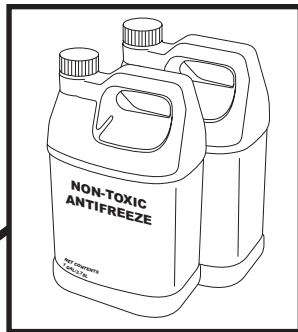

! WARNING! !	
	<p>TWO CAPABLE ADULTS REQUIRED FOR THIS PROCEDURE. FAILURE TO FOLLOW THIS WARNING COULD RESULT IN SERIOUS INJURY AND/OR PROPERTY DAMAGE.</p>
	<p>DO NOT LEAVE ASSEMBLY UNATTENDED WHEN EMPTY; IT MAY TIP OVER.</p>
! CAUTION! !	
	<p>ADD TWO GALLONS (7.6 LITERS) OF NON-TOXIC ANTIFREEZE IN BOTTOM BASE FOR SUB-FREEZING CLIMATES.</p>
	<p><i>IF USING SAND:</i> 2 GALLONS OF ANTI-FREEZE IS <u>NOT</u> REQUIRED.</p>

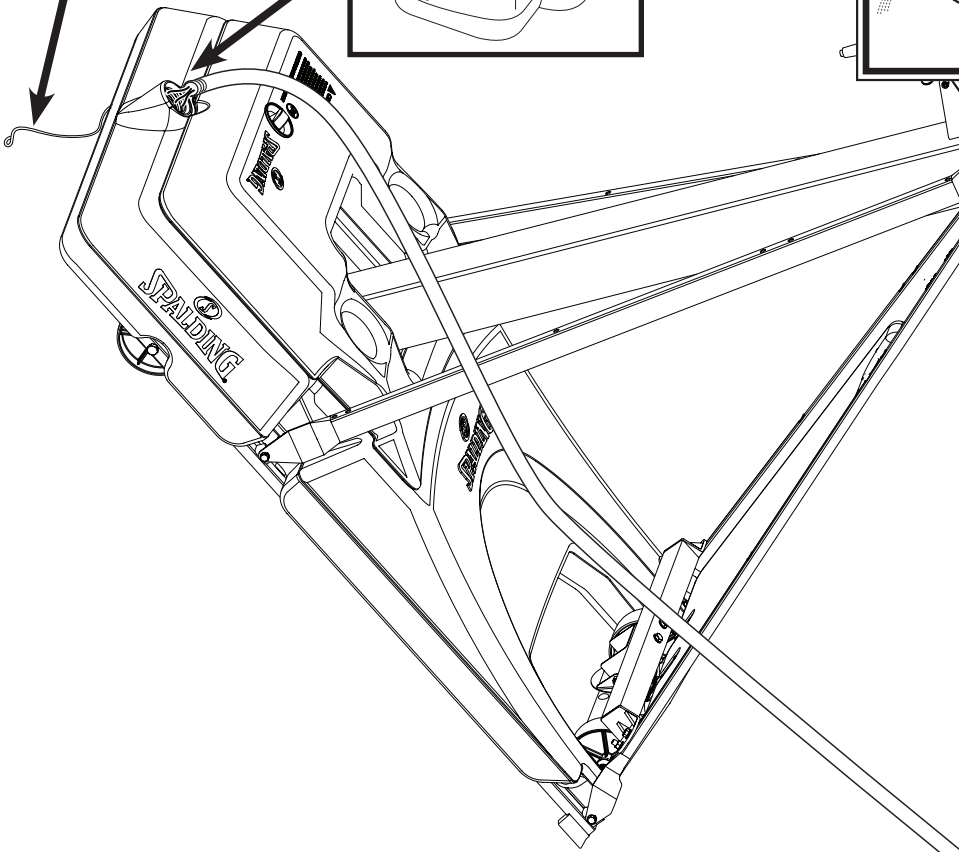

6.

Roll completed assembly to desired position.

After system is placed in an upright position, **COMPLETE** the filling process in **BOTH** bases.

If using **WATER**, the total amounts are as follows:

Top Base: approx. 9.8 gallons (37.1 liters)

Bottom Base: approx. 49 gallons (186 liters)

If using **SAND**, the total amounts are as follows:

Top Base: approx. 117 lbs. (53.1 kg)

Bottom Base: approx. 590 lbs. (268 kg)

Rotate caps (33) securely into **BOTH** bases.



WARNING!

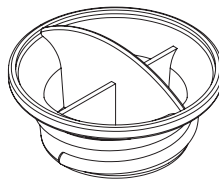

Cap (33) **MUST** be tightened **COMPLETELY** and **SECURELY** to prevent leakage.
CHECK WATER LEVEL BEFORE EACH USE! FAILURE TO FOLLOW THIS WARNING COULD RESULT IN SERIOUS INJURY AND/OR PROPERTY DAMAGE.



WARNING!



TWO CAPABLE ADULTS REQUIRED FOR THIS PROCEDURE. FAILURE TO FOLLOW THIS WARNING COULD RESULT IN SERIOUS INJURY AND/OR PROPERTY DAMAGE.



DO NOT LEAVE ASSEMBLY UNATTENDED WHEN EMPTY; IT MAY TIP OVER.



CAUTION!



ADD ONE GALLONS (7.6 LITERS) OF NON-TOXIC ANTIFREEZE IN TOP BASE FOR SUB-FREEZING CLIMATES.



***IF USING SAND:* 2 GALLONS OF ANTI-FREEZE IS NOT REQUIRED.**

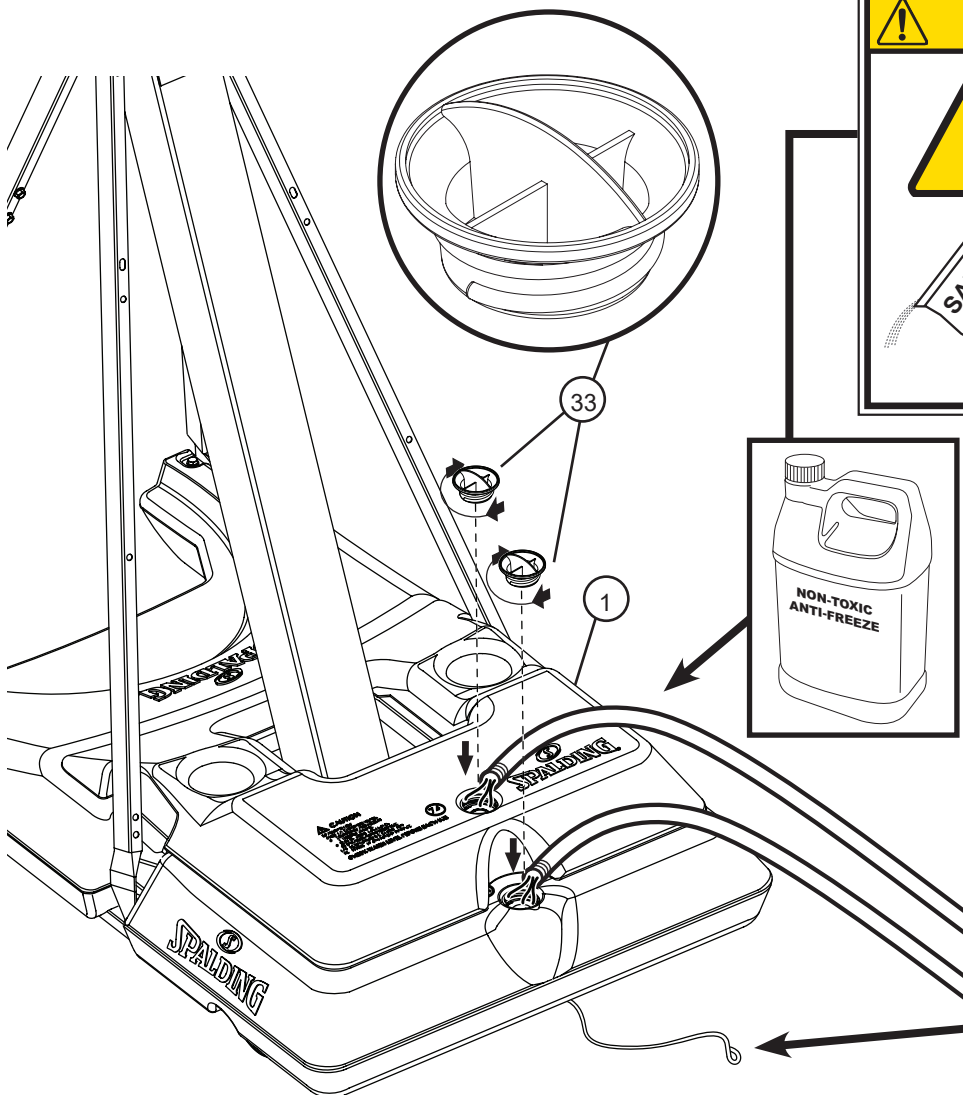

NOTE:

Make sure that the anchor rope is centered.

SECTION E: ATTACH BOARD RIM

RIM ATTACHMENT HARDWARE AND BAG

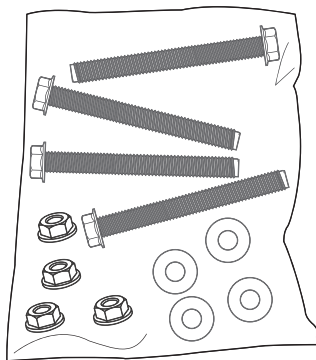

222700

HARDWARE LIST AND IDENTIFIER

<u>Item</u>	<u>Qty.</u>	<u>Part No.</u>	<u>Description</u>
32	1		Backboard
40	1		Rim
41	1		Net

<u>Item</u>	<u>Qty.</u>	<u>Part No.</u>	<u>Description</u>
R1	4	201611	Bolt, Hex-Flange, 5/16-18 x 3" Long
R2	4	203309	Washer, 3/8, 1: O.D.
R3	4	203100	Nut, Hex-Flange, 5/16-18



#R1 (4)

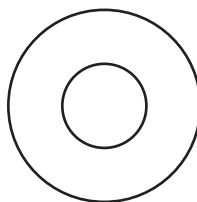

#R2 (4)

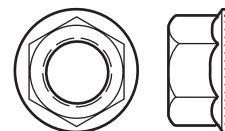

#R3 (4)

TOOLS REQUIRED FOR THIS SECTION

Phillips Screwdriver

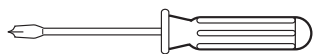

(2) Wrenches



1/2" 9/16"

Sawhorse or
Support Table

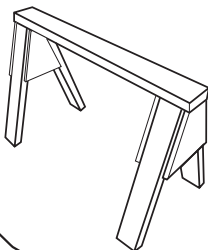

AND/OR

(2) Socket Wrenches & Sockets

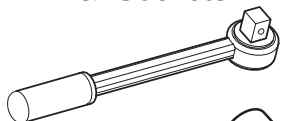

1/2"

9/16"

Extension

1.

Remove screws that secure rim cover.

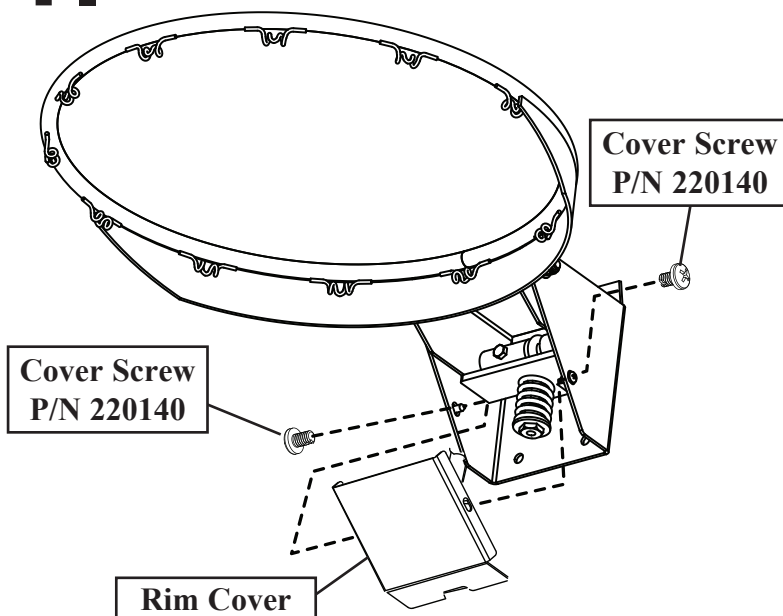



WARNING! AVERTISSEMENT! WARNUNG! ¡ADVERTENCIA!



PLEASE ENSURE that foam pad and all 4 steel spacers are in position **BEFORE** attaching yokes.
Failure to follow these instructions could result in personal injury or damage to property.

VEUILLEZ VOUS ASSURER que la mousse pad et tous les 4 entretoises en acier sont en position **AVANT** de fixer les chapes.
Le non-respect de ces instructions peut entraîner des blessures ou des dommages à la propriété.

BITTE STELLEN SIE SICHER dass Schaumstoff und alle 4 Distanzstücke aus Stahl sind in Position befindet **BEVOR** mit der installation gabeln.
Bei Nichtbeachtung dieser Anweisungen kann zu Verletzungen oder Schäden an Eigentum.

POR FAVOR, ASEGÚRESE de que almohadilla de espuma y los 4 separadores de acero están en su posición correcta **ANTES** de conectar las horquillas.
El incumplimiento de estas instrucciones puede resultar en lesiones personales o daños a la propiedad.

- 2.** Adjust backboard to lowest setting and attach rim assembly (40) to board using bolts (R1), washers (R2), foam pad (35), steel spacers (34) and nuts (R3).

CAUTION: / PRÉCAUTION:
VORSICHT: / EI CUIDADO:

Ensure that (4) steel spacers are in place before assembling rim.

Assurez-vous que (4) les entretoises d'acier sont en place avant d'assembler la jante.

Garantieren sie, dass (4) stahl-distanzscheiben existieren, bevor sie kante zusammenbauen.

Asegúrese de que los espaciadores de acero (4) están en su lugar antes de montar la llanta.

12/12 P/N 500046

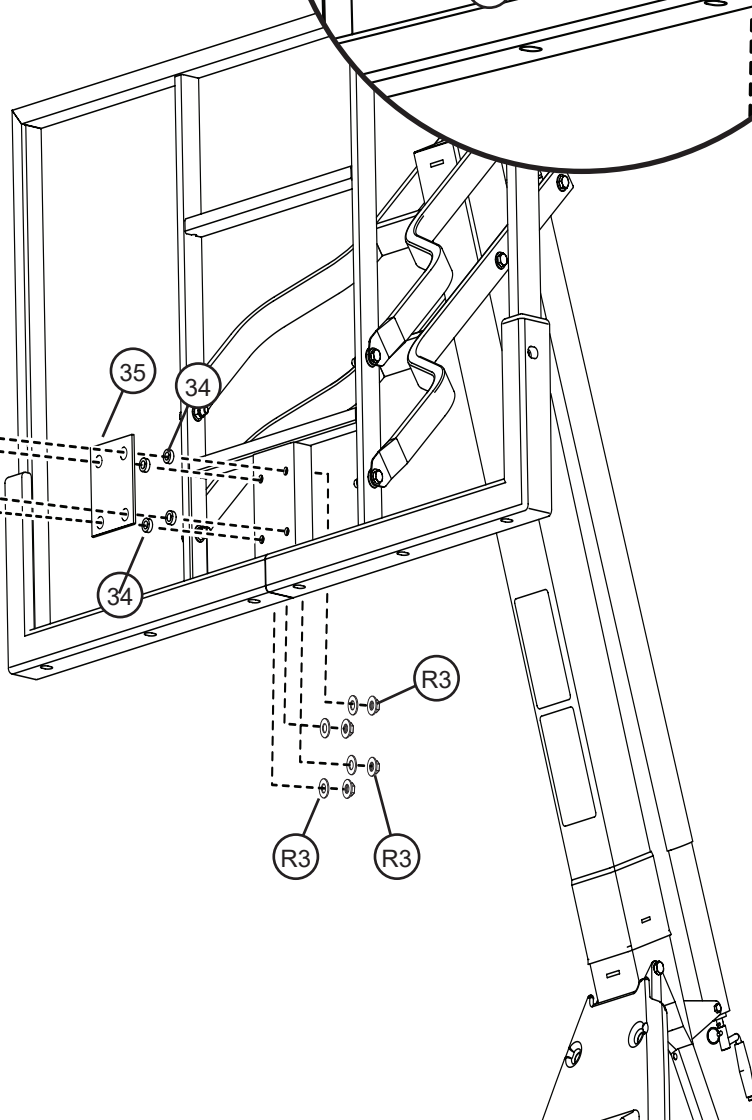
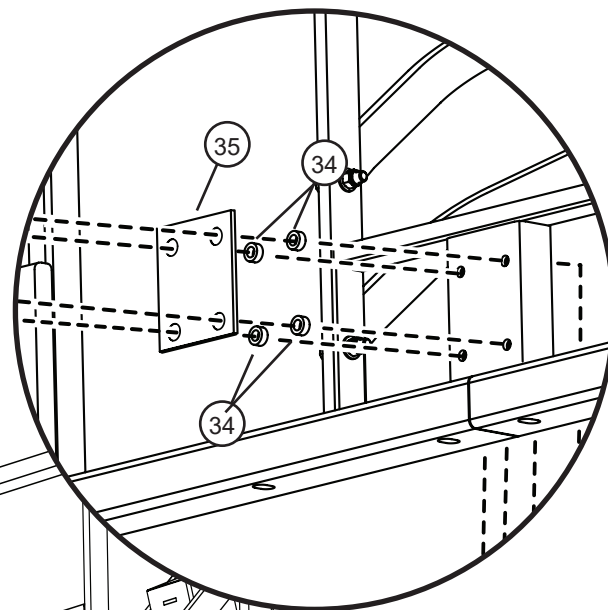
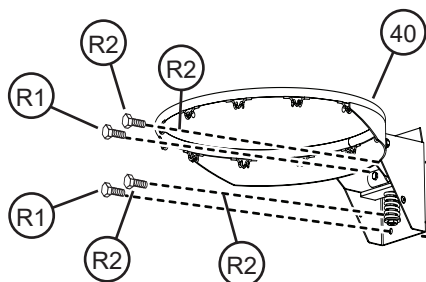

CAUTION!

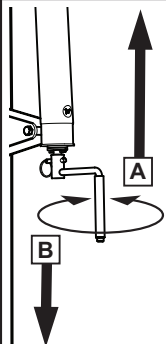

DO NOT OVER-CRANK
HANDLE BEYOND THE
MANUFACTURED HEIGHT-
INDICATOR RANGE OF
7-1/2 - 10 FEET. DAMAGE
MAY BE CAUSED TO THE
SCREW JACK'S INTERNAL
ADJUSTMENT MECHANISM
IF ADJUSTED OVER 10 OR
UNDER 7-1/2 FEET.

TO ADJUST RIM TENSION

3. Make adjustments as shown.

Tightening the nut:

- Increases the preload on the spring and increases the rim's resistance to movement.
- The higher the preload, the more force required to move the rim downward.

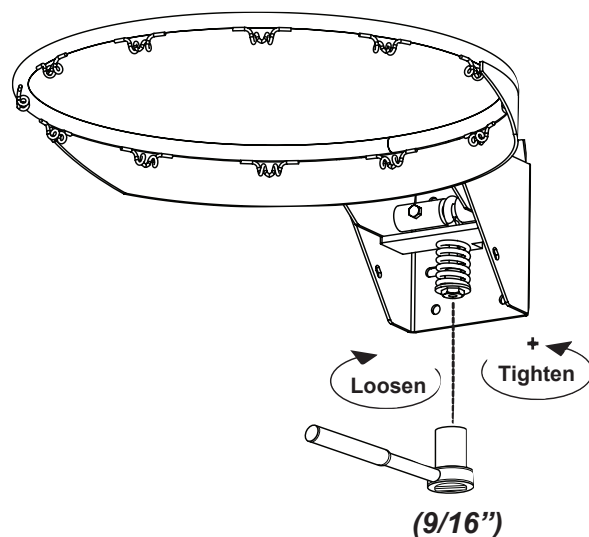

4. Install cover plate on rim (40) using self tapping screws removed in step 1 of this section (note orientation of cover plate).

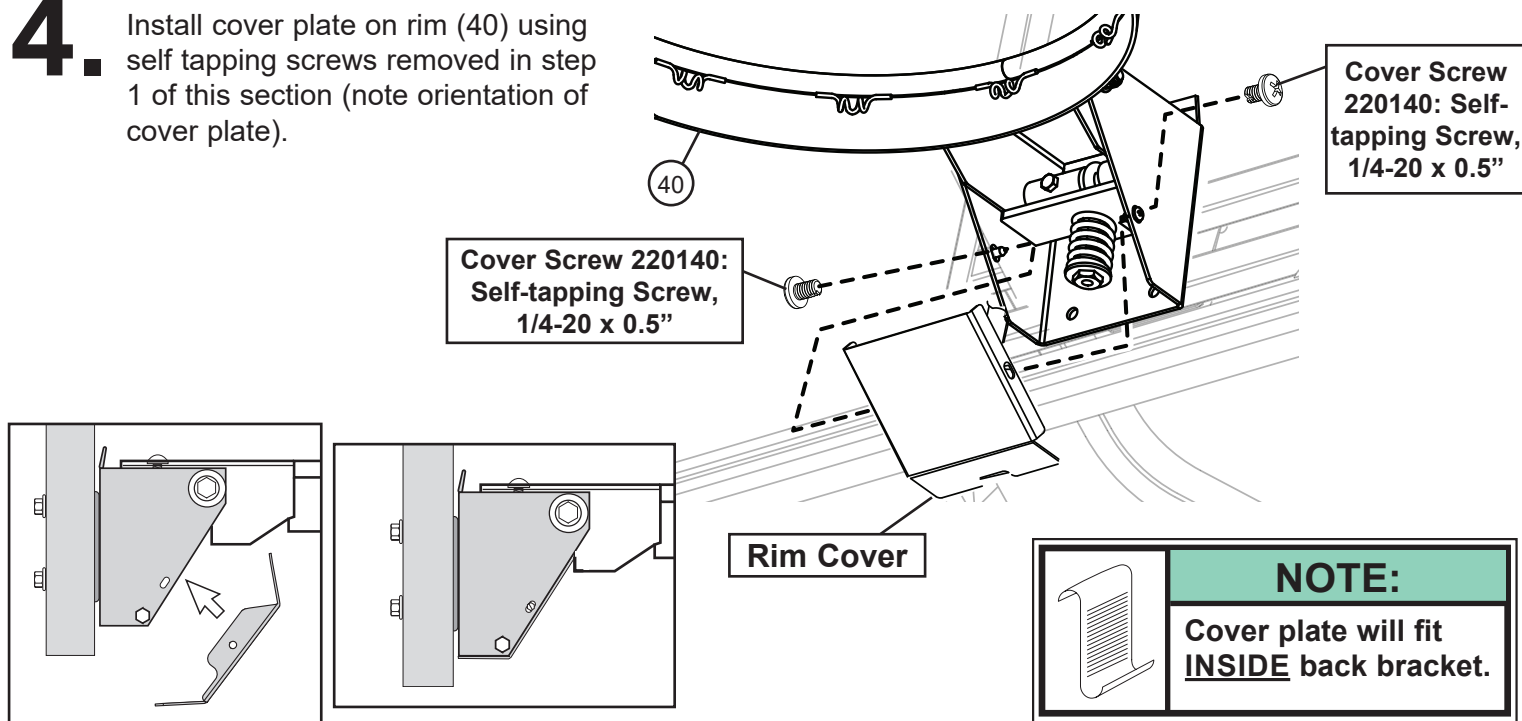

5. Install net (41).

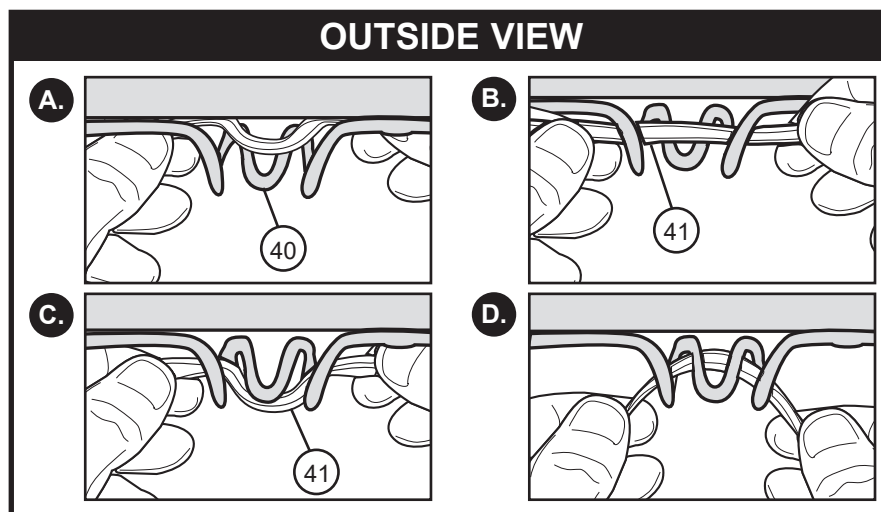

SECTION F: STADIUM PAD AND FINALIZING SET-UP

STADIUM AND BOARD PAD HARDWARE CARD

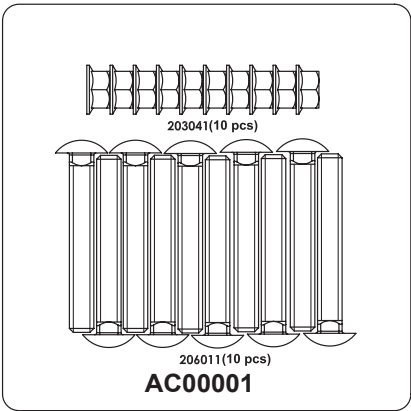

HARDWARE LIST AND IDENTIFIER

<u>Item</u>	<u>Qty.</u>	<u>Part No.</u>	<u>Description</u>	<u>Item</u>	<u>Qty.</u>	<u>Part No.</u>	<u>Description</u>
50	1	600077	Stadium Pad, Bottom	53	1	574090	Label, Height Adjustment and Moving
51	1	600078	Stadium Pad, Top	P1	10	206011	Bolt, Carriage, 3/8-16 x 2.75" Long
52	1	203124	Ground Stake	P2	10	203041	Nut, Hex-Flange, 3/8-16
				54	1	204872	Label, Height Indicator

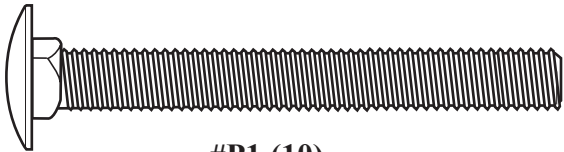

#P1 (10)

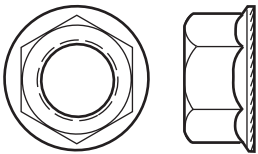

#P2 (10)

TOOLS REQUIRED FOR THIS SECTION

(2) Wrenches



9/16"

AND/OR

(2) Socket Wrenches and Sockets

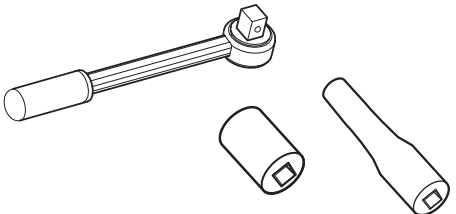

9/16"

Extension

STADIUM PAD - INSTALLATION

1. Attach top stadium pad (51) with bolts (P1) and Nuts (P2).

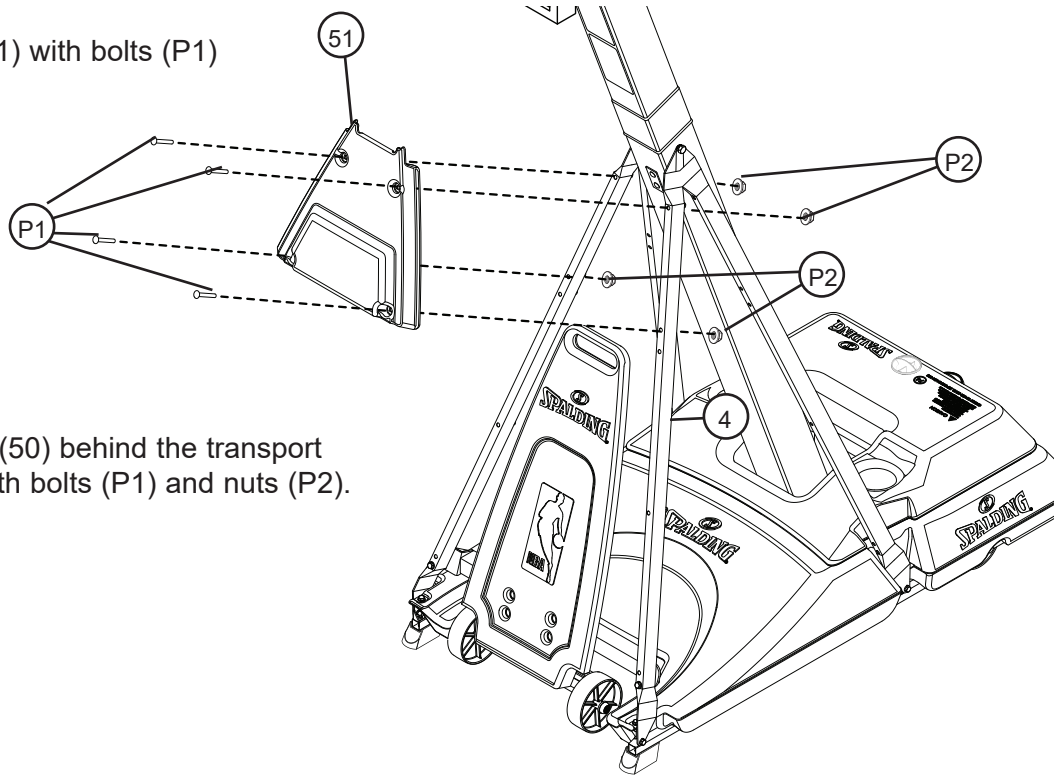

2. Slide bottom stadium pad (50) behind the transport handle (11) and secure with bolts (P1) and nuts (P2).

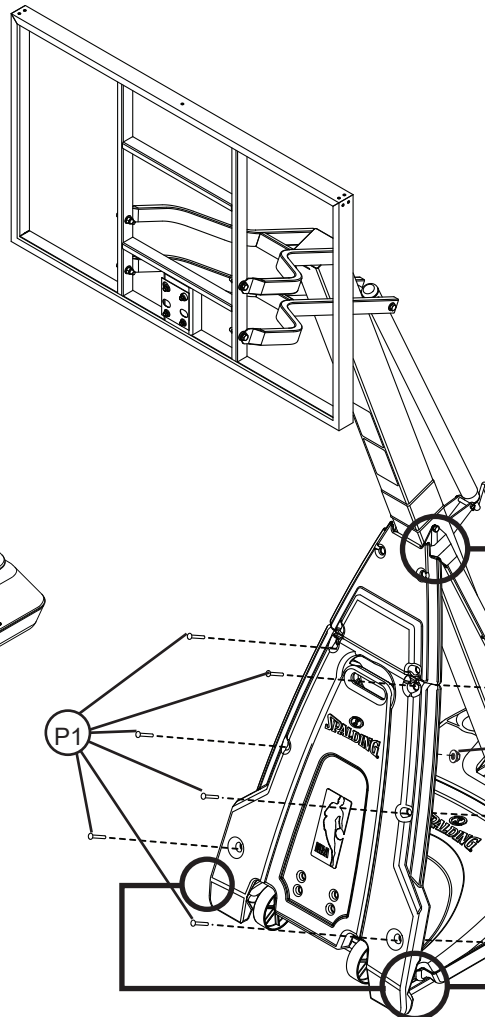
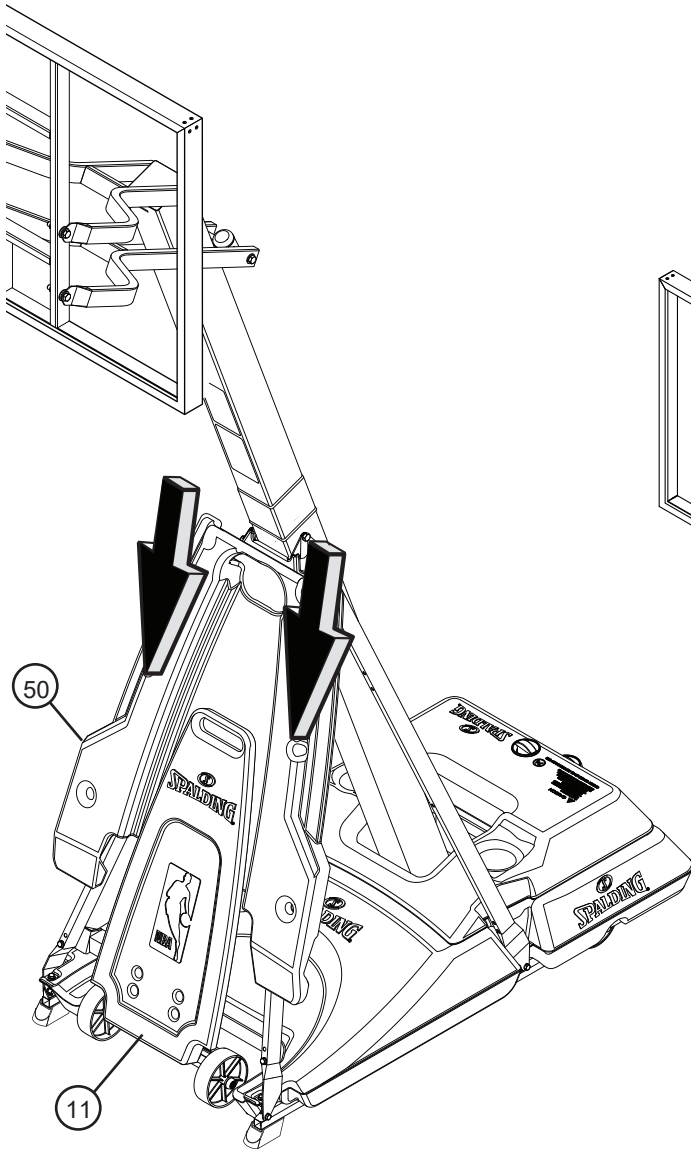

NOTE:

If necessary, slightly loosen bolts that secure front struts to pole and base frame (circled areas).

RETIGHTEN after stadium pads are attached.

3. Secure system by hooking loose end of rope onto ground stake (52).

Place stake so that when it is screwed into the ground the rope is taut.

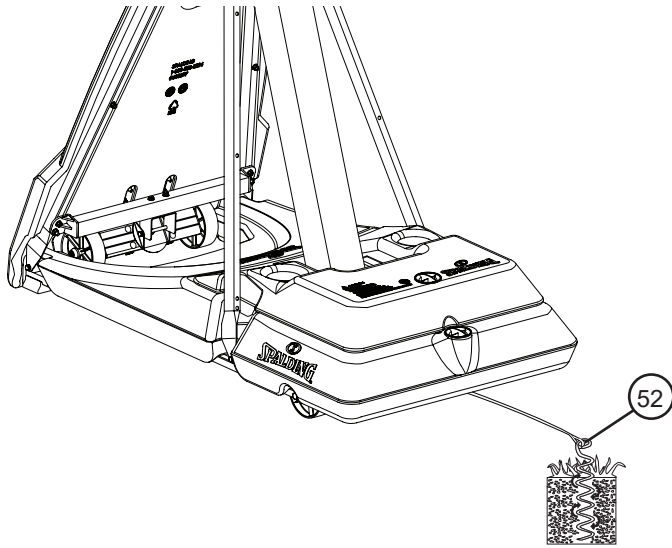

CAUTION!	
	<p>DO NOT OVER-CRANK HANDLE BEYOND THE MANUFACTURED HEIGHT-INDICATOR RANGE OF 7-1/2 - 10 FEET. DAMAGE MAY BE CAUSED TO THE SCREW JACK'S INTERNAL ADJUSTMENT MECHANISM IF ADJUSTED OVER 10 OR UNDER 7-1/2 FEET.</p>
	<p>HEIGHT AND MOVING LABEL MUST NOT OBSTRUCT FACTORY ATTACHED WARNING LABEL.</p>

4. Apply Height Adjustment and Moving Label (53) to front of pole, where it is clearly visible.

NOTE:

If elevator is hard to adjust, slightly loosen bolts (circled areas).

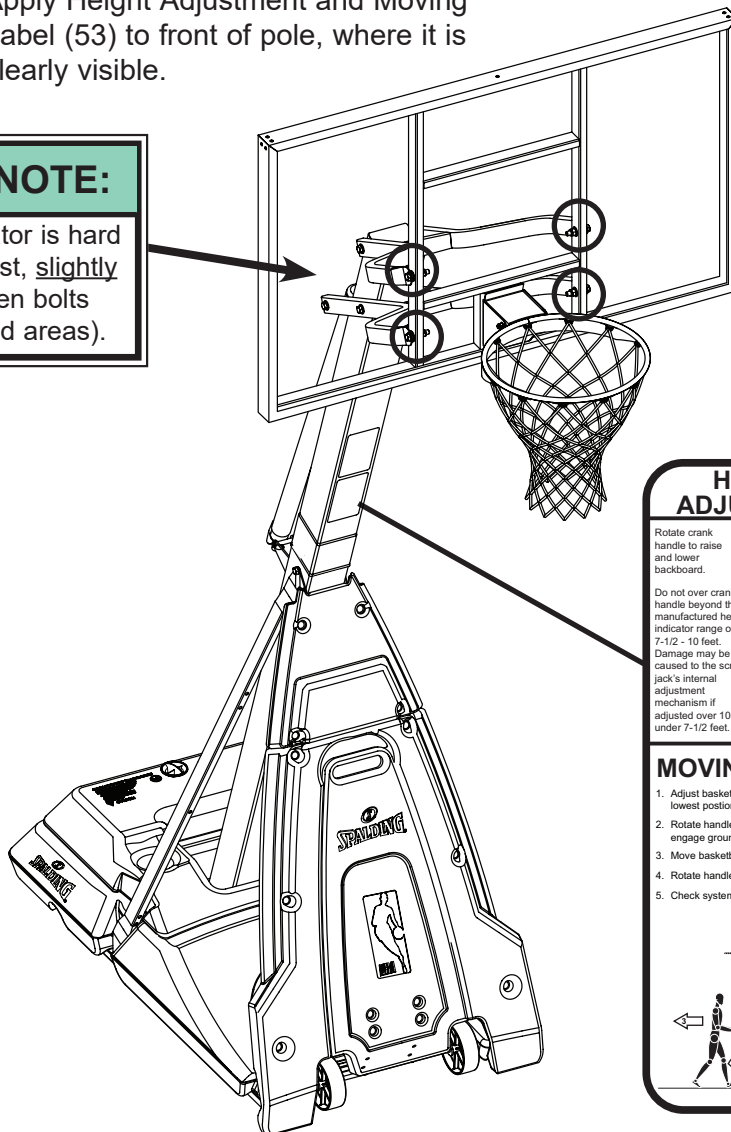

NOTE:

Handle (20) can be removed and stored by removing pin (24).

53

HEIGHT ADJUSTMENT

Rotate crank handle to raise and lower backboard.

Do not over crank handle beyond the manufactured height indicator range of 7-1/2 - 10 feet. Damage may be caused to the screw jack's internal adjustment mechanism if adjusted over 10 or under 7-1/2 feet.

MOVING SYSTEM

1. Adjust basketball backboard height to lowest position.
2. Rotate handle forward until wheels engage ground.
3. Move basketball system to desired location.
4. Rotate handle back to original position.
5. Check system for stability.

574090 12/06

NOTE:

Official rim height is 10-0' (3.05 m) from top of rim to playing surface.

10 ft. (3.05M)

APPLY HEIGHT INDICATOR DECALS

- 1.** Apply Height Indicator Labels (54) to screw jack using a tape measure.
Tools needed for this operation - Tape measure, Step Ladder 8 ft.

A Step 1 - Set unit to 7-1/2 feet (2.3 m) by adjusting the screw jack and measuring from the top of the rim to the playing surface. Place 7-1/2' (2.3 m) sticker in the middle of the hole of the screw jack cover as shown.

B Step two - Using a tape measure, set unit to 7 1/2 feet (2,3m) by adjusting the screw-jack and measuring from the top of the rim to the playing surface. Place the 7-1/2 foot (2,3m) sticker in the middle of the hole of the screw-jack cover as shown.

C Step three - Repeat step two for each subsequent height until the last sticker is in place at the 10 foot (3,04m) height.

